

OVERSIZED 4- CAR GARAGE, EASY COMMUTE TO METRO AREA & DIA.



 Single Family

 2990 SQFT

 5 Beds

 3 Baths

 2 Car

 0.38 Acre

1954 Long Branch, Strasburg, CO 80136 – All Levels

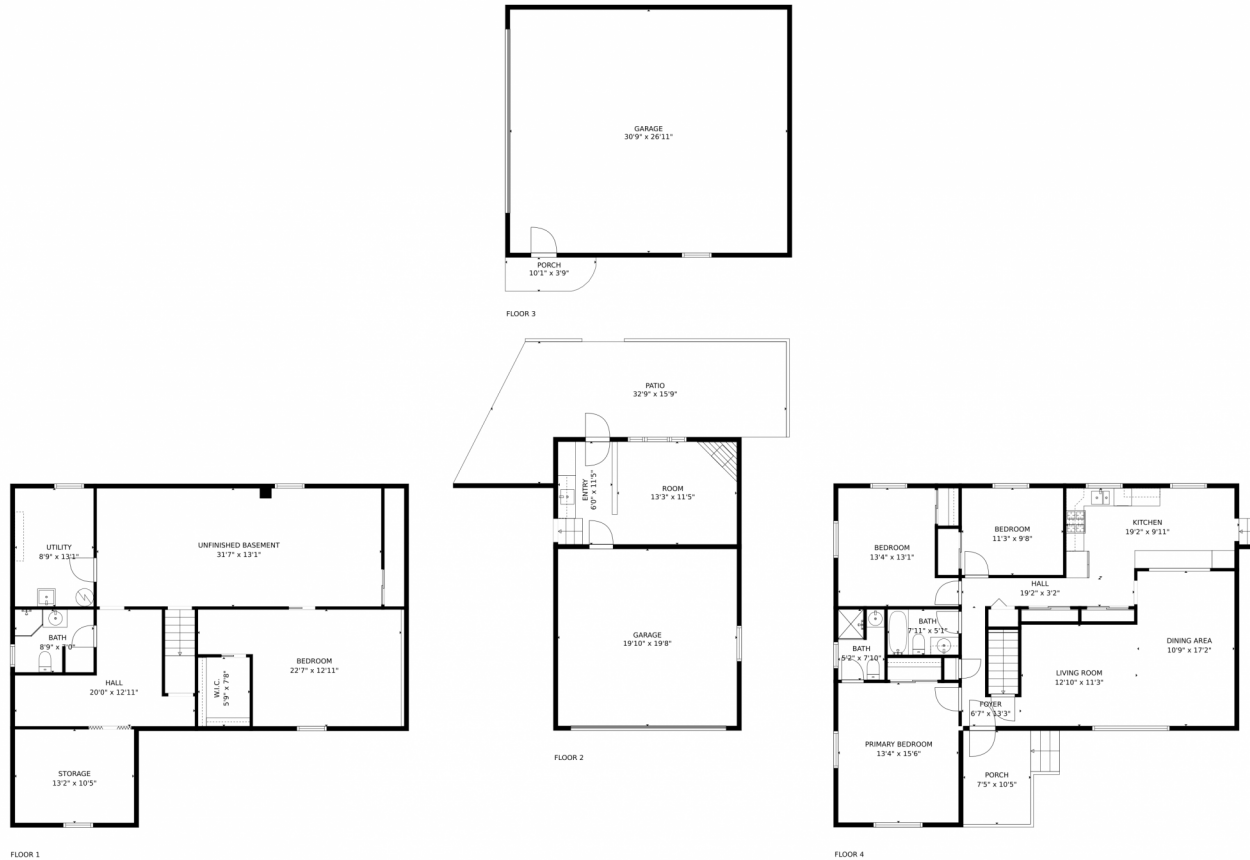

TOTAL: 2117 sq. ft
 Below Ground: 578 sq. ft, FLOOR 2: 226 sq. ft, FLOOR 3: 0 sq. ft, FLOOR 4: 1313 sq. ft
 EXCLUDED AREAS: STORAGE: 137 sq. ft, UTILITY: 119 sq. ft, UNDEFINED: 33 sq. ft,
 UNFINISHED BASEMENT: 414 sq. ft, GARAGE: 1221 sq. ft, PATIO: 386 sq. ft,
 PORCH: 114 sq. ft

MEASUREMENTS CALCULATED BY V1Photos.COM ARE DEEMED HIGHLY RELIABLE BUT NOT GUARANTEED.



Disclaimer: Sizes and Dimensions are Approximate, Actual May Vary.

Eric Hart
 303-818-9951
 eric@homeandlandrealty.net

