 Single Family

 1440 SQFT

 3 Beds

 2/1 Baths



Taylor Haas
303-665-7368
taylorh@coloradorpm.com
<https://www.coloradorpm.com/available-rental-properties-denver>



18128 Caffey Drive, Parker, CO 80134 – Main Level

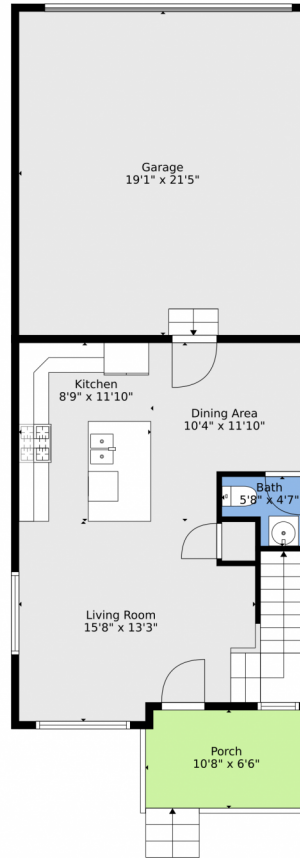

TOTAL: 1316 sq. ft
FLOOR 1: 465 sq. ft, FLOOR 2: 851 sq. ft
EXCLUDED AREAS: GARAGE: 408 sq. ft, PORCH: 69 sq. ft, ELECTRICAL ROOM: 17 sq. ft

Floor Plan Created By V1photos.com, Measurements Deamed Highly Reliable But Not Guaranteed.



Disclaimer: Sizes and Dimensions are Approximate, Actual May Vary.



Taylor Haas
303-665-7368
taylorh@coloradorpm.com
<https://www.coloradorpm.com/available-rental-properties-denver>



Scan code
for more
property
details

18128 Caffey Drive, Parker, CO 80134 – Second Level

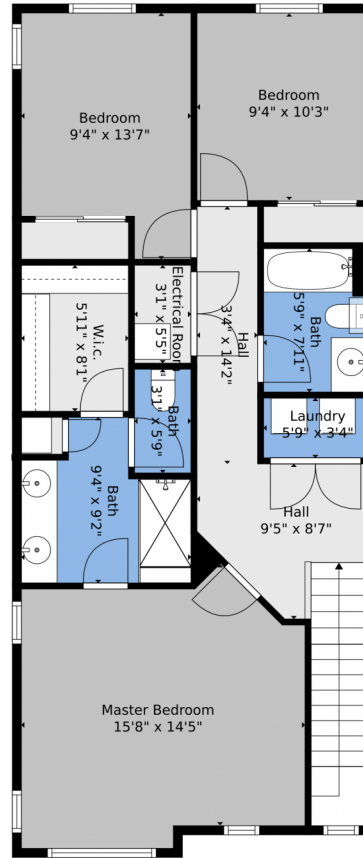

TOTAL: 1316 sq. ft
FLOOR 1: 465 sq. ft, FLOOR 2: 851 sq. ft
EXCLUDED AREAS: GARAGE: 408 sq. ft, PORCH: 69 sq. ft, ELECTRICAL ROOM: 17 sq. ft

Floor Plan Created By V1photos.com, Measurements Deamed Highly Reliable But Not Guaranteed.



Disclaimer: Sizes and Dimensions are Approximate, Actual May Vary.



Taylor Haas
303-665-7368
taylorh@coloradorpm.com
<https://www.coloradorpm.com/available-rental-properties-denver>



18128 Caffey Drive, Parker, CO 80134 – All Levels



TOTAL: 1316 sq. ft
FLOOR 1: 465 sq. ft, FLOOR 2: 851 sq. ft
EXCLUDED AREAS: GARAGE: 408 sq. ft, PORCH: 69 sq. ft, ELECTRICAL ROOM: 17 sq. ft

Floor Plan Created By V1photos.com, Measurements Deamed Highly Reliable But Not Guaranteed.



Disclaimer: Sizes and Dimensions are Approximate, Actual May Vary.



Taylor Haas
303-665-7368
taylorh@coloradorpm.com
<https://www.coloradorpm.com/available-rental-properties-denver>

