



5625 Twilight Way
 Parker, CO 80134
 COMMUNITY: Pradera

MLS # 8961378



Single Family



8927 SQFT



6 Beds



8 Baths



5 Car



1.96 Acre

PROPERTY DETAILS

Discover the elegance of 5625 Twilight Way, a luxurious haven in the prestigious Pradera golf community! This custom home offers supreme privacy, breathtaking views, and enviable details around every corner. With mountain-contemporary touches, the home features a stunning foyer, open-concept family room, chef's kitchen, and a main-floor primary suite. The walk-out lower level includes a second kitchen, home theater, gym, game room, and wine cellar. The home's exceptional outdoor living spaces are perfect for gatherings, with decks, patios, a firepit, and outdoor fireplace. Revel in the grandeur of the incredible custom 5-car garage! Enjoy the Pradera Golf Club, just a golf cart ride away.



Natalie Force
 303-328-8015
 nataliecontracts@stellerrealestate.com
<https://www.stellerrealestate.com/agents/natalie-force/>



Scan code
 for more
 property
 details



5625 Twilight Way, Parker, CO 80134 – All Levels

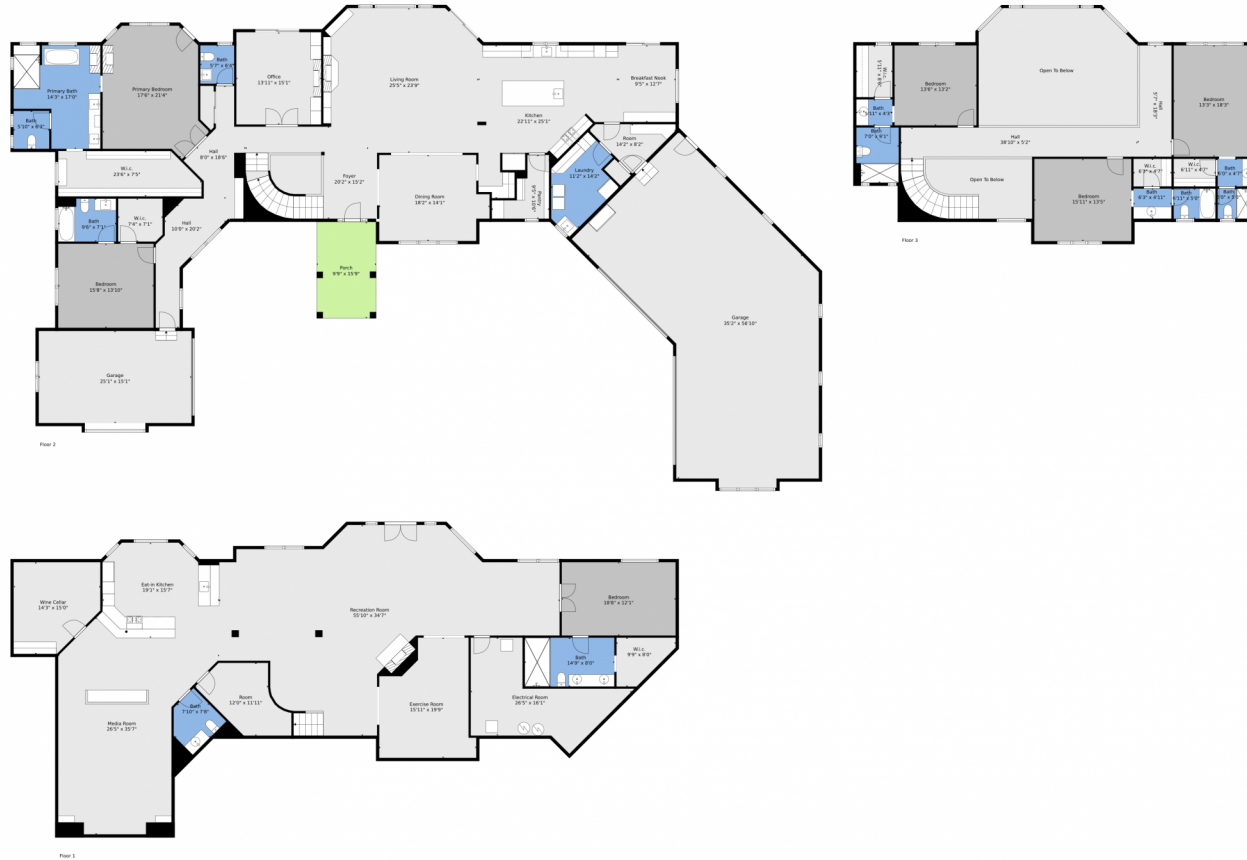

TOTAL: 8006 sq. ft
 BELOW GROUND: 3040 sq. ft, FLOOR 2: 3567 sq. ft, FLOOR 3: 1399 sq. ft
 EXCLUDED AREAS: ELECTRICAL ROOM: 258 sq. ft, WINE CELLAR: 189 sq. ft, GARAGE: 1756 sq. ft,
 PORCH: 154 sq. ft, BAY WINDOW: 11 sq. ft, OPEN TO BELOW: 610 sq. ft

Floor Plan Created By V1photos.com, Measurements Deamed Highly Reliable But Not Guaranteed.



Disclaimer: Sizes and Dimensions are Approximate, Actual May Vary.



Natalie Force
 303-328-8015
 nataliecontracts@stellerrealestate.com
<https://www.stellerrealestate.com/agents/natalie-force/>



Scan code
 for more
 property
 details

