

COMPASS

12952 East 107th Avenue
Commerce City, CO 80022
COMMUNITY: Turnberry



Single Family



3234 SQFT



3 Beds



2/1 Baths



3 Car



0.24 Acre



Joline Andasola

720-936-2824

joline.andasola@compass.com

<https://www.facebook.com/coloradomoveinrealestate>



Scan code
for more
property
details



12952 East 107th Avenue, Commerce City, CO 80022 – Main Level



TOTAL: 1816 sq. ft
Below Ground: 70 sq. ft, FLOOR 2: 1746 sq. ft
EXCLUDED AREAS: BASEMENT: 1171 sq. ft, GARAGE: 619 sq. ft, PORCH: 70 sq. ft,
PATIO: 216 sq. ft

Floor Plan Created By V1photos.com, Measurements Deamed Highly Reliable But Not Guaranteed.



Disclaimer: Sizes and Dimensions are Approximate, Actual May Vary.



Joline Andasola
720-936-2824
joline.andasola@compass.com
<https://www.facebook.com/coloradomoveinrealestate>



Scan code
for more
property
details



12952 East 107th Avenue, Commerce City, CO 80022 – lower Level

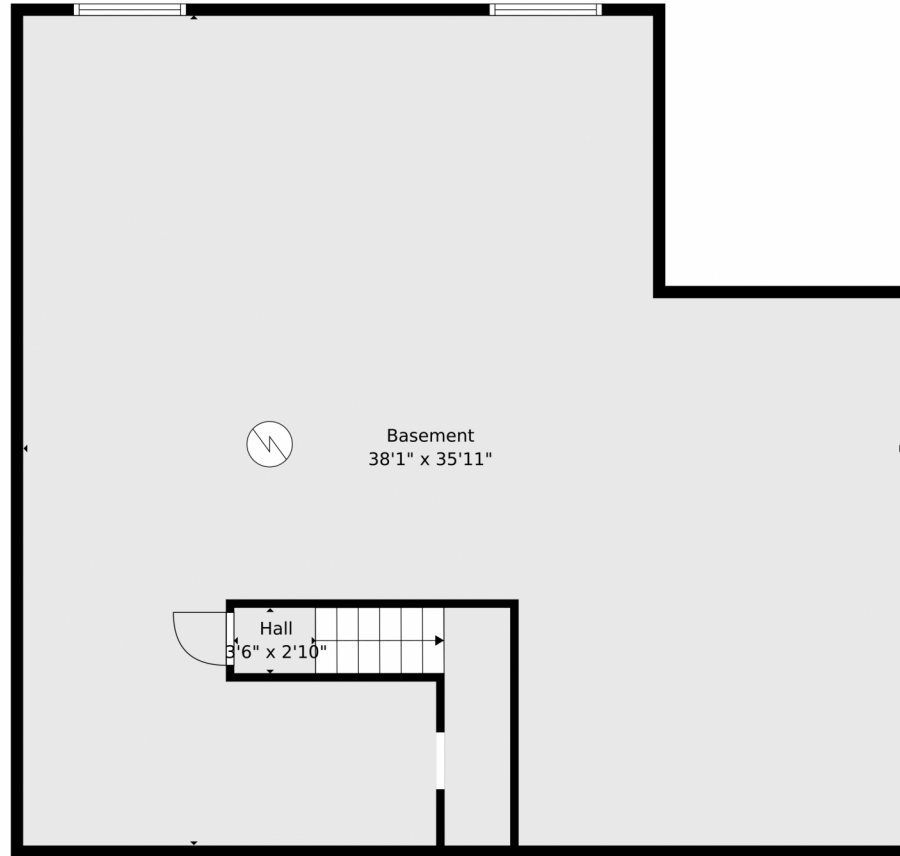

TOTAL: 1816 sq. ft
Below Ground: 70 sq. ft, FLOOR 2: 1746 sq. ft
EXCLUDED AREAS: BASEMENT: 1171 sq. ft, GARAGE: 619 sq. ft, PORCH: 70 sq. ft,
PATIO: 216 sq. ft

Floor Plan Created By V1photos.com, Measurements Deamed Highly Reliable But Not Guaranteed.



Disclaimer: Sizes and Dimensions are Approximate, Actual May Vary.



Joline Andasola
720-936-2824
joline.andasola@compass.com
<https://www.facebook.com/coloradomoveinrealestate>



12952 East 107th Avenue, Commerce City, CO 80022 – All Levels



TOTAL: 1816 sq. ft
Below Ground: 70 sq. ft, FLOOR 2: 1746 sq. ft
EXCLUDED AREAS: BASEMENT: 1171 sq. ft, GARAGE: 619 sq. ft, PORCH: 70 sq. ft,
PATIO: 216 sq. ft

Floor Plan Created By V1photos.com. Measurements Deamed Highly Reliable But Not Guaranteed.



Disclaimer: Sizes and Dimensions are Approximate, Actual May Vary.



Joline Andasola
720-936-2824
joline.andasola@compass.com
<https://www.facebook.com/coloradomoveinrealestate>

