



Single Family 2796 SQFT 6 Beds 3 Baths 1 Car 0.22 Acre

### PROPERTY DETAILS

Remodel living in stunning home in Fort Lupton. 9,000 sq ft lot. Open-concept design, perfect for entertaining. Beautiful patio and garden. Convenient location. Must see masterpiece.



**Yenifer Portillo**  
303-853-4173  
yenifer.sellingco05@gmail.com





**TOTAL: 2598 sq. ft**  
BELOW GROUND: 1287 sq. ft, FLOOR 2: 1311 sq. ft  
EXCLUDED AREAS: GARAGE: 1368 sq. ft, PATIO: 1045 sq. ft, PORCH: 204 sq. ft  
Floor Plan Created By V1photos.com, Measurements Deamed Highly Reliable But Not Guaranteed.

Disclaimer: Sizes and Dimensions are Approximate, Actual May Vary.



**Yenifer Portillo**  
303-853-4173  
yenifer.sellingco05@gmail.com

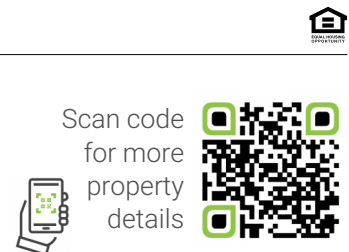

# 430 Harrison Ave, Fort Lupton, CO 80621 – Main Level



**TOTAL: 2598 sq. ft**  
BELOW GROUND: 1287 sq. ft, FLOOR 2: 1311 sq. ft  
EXCLUDED AREAS: GARAGE: 1368 sq. ft, PATIO: 1045 sq. ft, PORCH: 204 sq. ft

Floor Plan Created By V1photos.com, Measurements Deamed Highly Reliable But Not Guaranteed.

Disclaimer: Sizes and Dimensions are Approximate, Actual May Vary.



**Yenifer Portillo**  
303-853-4173  
yenifer.sellingco05@gmail.com



# 430 Harrison Ave, Fort Lupton, CO 80621 – All levels

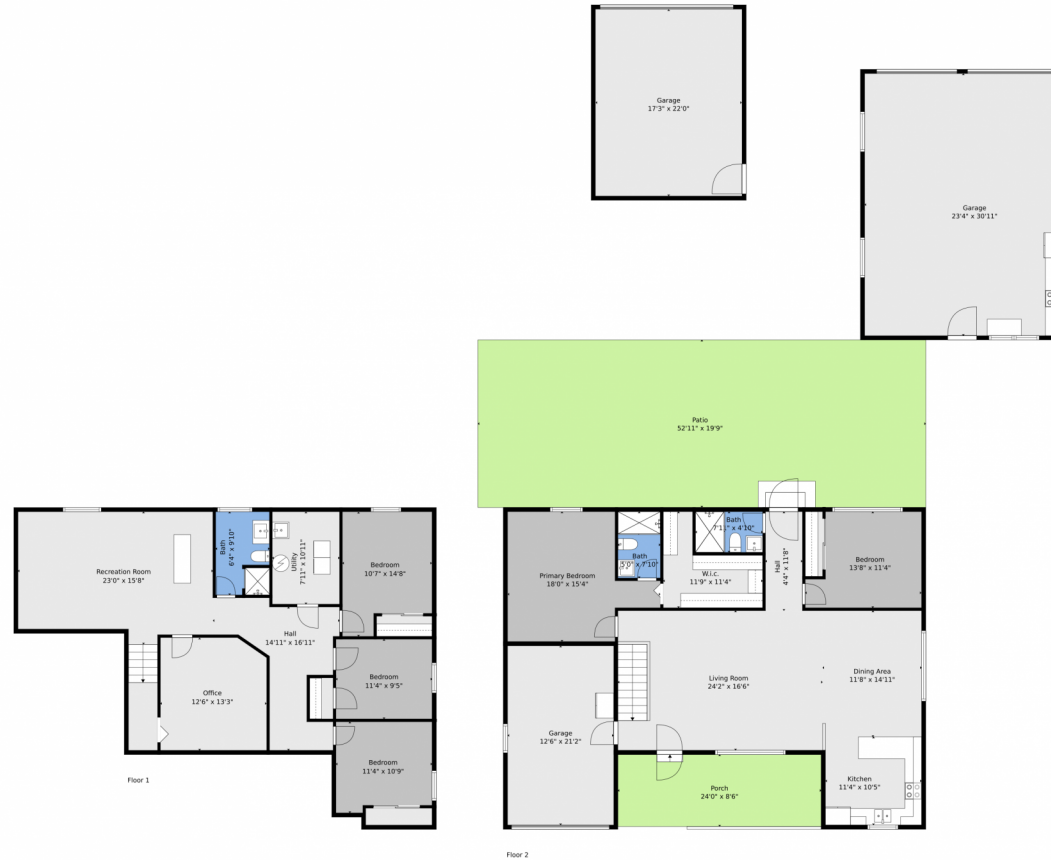

**TOTAL: 2598 sq. ft**  
BELOW GROUND: 1287 sq. ft, FLOOR 2: 1311 sq. ft  
EXCLUDED AREAS: GARAGE: 1368 sq. ft, PATIO: 1045 sq. ft, PORCH: 204 sq. ft  
Floor Plan Created By V1photos.com, Measurements Deamed Highly Reliable But Not Guaranteed.

Disclaimer: Sizes and Dimensions are Approximate, Actual May Vary.



**Yenifer Portillo**  
303-853-4173  
yenifer.sellingco05@gmail.com

