



 Single Family

 1601 SQFT

 3 Beds

 2 Baths



Taylor Haas
303-665-7368
taylorh@coloradorpm.com
<https://www.coloradorpm.com/available-rental-properties-denver>



1320 Basseterre Place, Fort Collins, CO 80525 – Lower Level

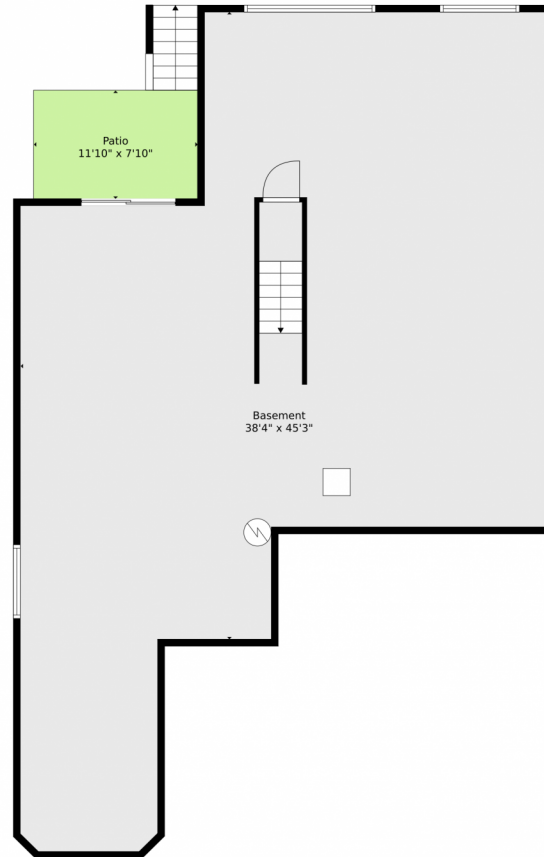

TOTAL: 1627 sq. ft
BELOW GROUND: 0 sq. ft, FLOOR 2: 1627 sq. ft
EXCLUDED AREAS: BASEMENT: 1537 sq. ft, PATIO: 93 sq. ft, GARAGE: 566 sq. ft,
DECK: 230 sq. ft, PORCH: 48 sq. ft

Floor Plan Created By V1photos.com, Measurements Deamed Highly Reliable But Not Guaranteed.

Disclaimer: Sizes and Dimensions are Approximate, Actual May Vary.



Taylor Haas
303-665-7368
taylorh@coloradorm.com
<https://www.coloradorm.com/available-rental-properties-denver>



1320 Basseterre Place, Fort Collins, CO 80525 – Main Level



TOTAL: 1627 sq. ft
BELOW GROUND: 0 sq. ft, FLOOR 2: 1627 sq. ft
EXCLUDED AREAS: BASEMENT: 1537 sq. ft, PATIO: 93 sq. ft, GARAGE: 566 sq. ft,
DECK: 230 sq. ft, PORCH: 48 sq. ft

Floor Plan Created By V1photos.com, Measurements Deamed Highly Reliable But Not Guaranteed.

Disclaimer: Sizes and Dimensions are Approximate, Actual May Vary.



Taylor Haas
303-665-7368
taylorh@coloradorpm.com
<https://www.coloradorpm.com/available-rental-properties-denver>



1320 Basseterre Place, Fort Collins, CO 80525 – All levels



TOTAL: 1627 sq. ft
BELOW GROUND: 0 sq. ft, FLOOR 2: 1627 sq. ft
EXCLUDED AREAS: BASEMENT: 1537 sq. ft, PATIO: 93 sq. ft, GARAGE: 566 sq. ft,
DECK: 230 sq. ft, PORCH: 48 sq. ft

Floor Plan Created By V1photos.com, Measurements Deamed Highly Reliable But Not Guaranteed.

Disclaimer: Sizes and Dimensions are Approximate, Actual May Vary.



Taylor Haas
303-665-7368
taylorh@coloradorpm.com
<https://www.coloradorpm.com/available-rental-properties-denver>

