



144 Mount Simon Drive
 Livermore, CO 80536
 COMMUNITY: Green Mountain Mdws 2 Filing

MLS
 # IR1018699
 PRICE \$600,000



Single Family 5907 SQFT 9 Beds 4/1 Baths 3 Car 35.01 Acre

PROPERTY DETAILS

Welcome to this expansive ranch-style estate with over 5,000 sq ft on 35+ acres, ideal for livestock and wildlife. The home features seven bedrooms, four bathrooms, and a remodeled in-law suite with a private entrance, kitchen, living area, and two bedrooms—perfect for guests or rentals. The main residence has updates yet offers customization potential. Enjoy country living with no HOA, private access to state land, and a three-car garage. Equestrian enthusiasts will love the horse facilities, fenced pasture, lean-to barn, and automatic heated water. The property also includes chicken coops and pheasant pens, catering to farming needs. This fixer-upper is priced for exceptional value and possibilities.



Jennifer Hart
 720-935-1137
 hartrealty1@gmail.com



144 Mount Simon Drive, Livermore, CO 80536 – Lower Level

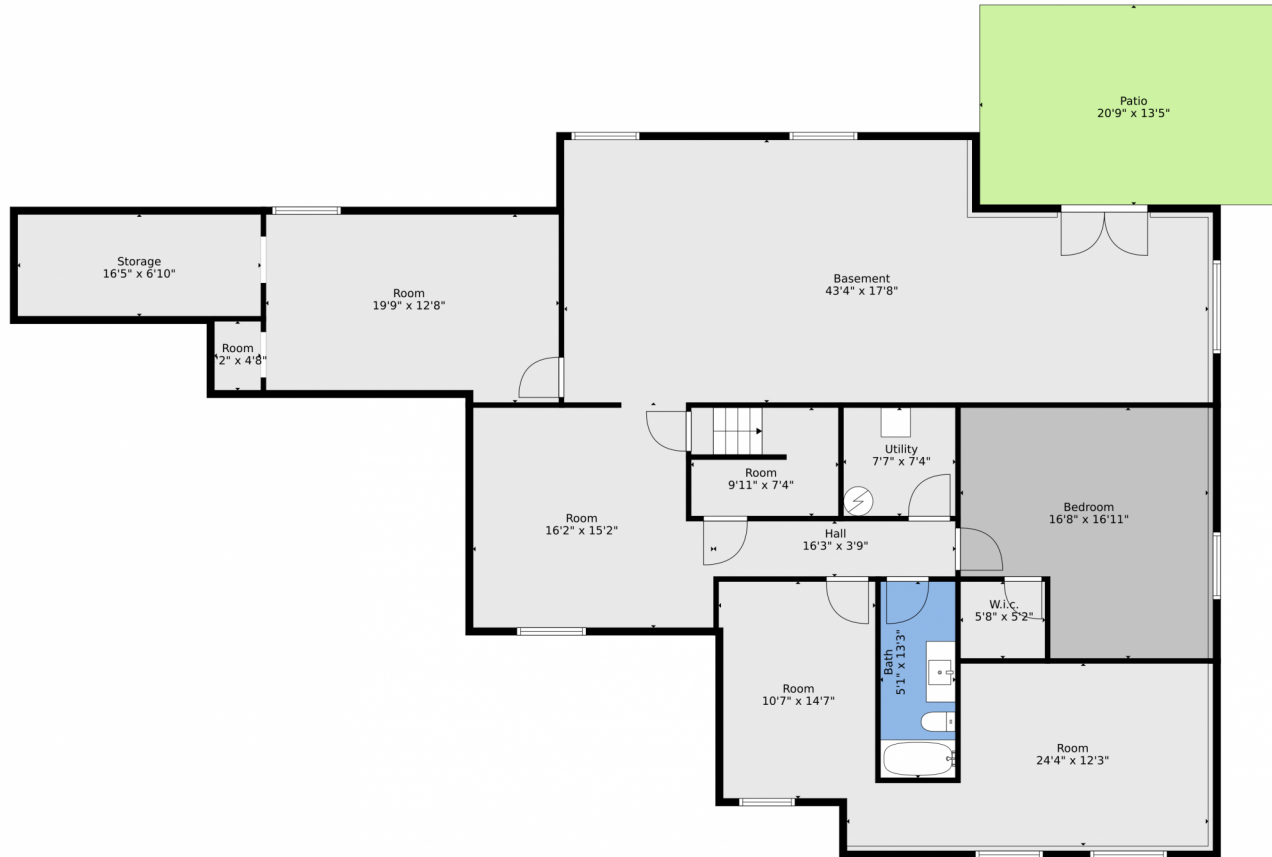

TOTAL: 4704 sq. ft
BELOW GROUND: 1484 sq. ft, FLOOR 2: 3220 sq. ft
EXCLUDED AREAS: STORAGE: 112 sq. ft, BASEMENT: 694 sq. ft, PATIO: 398 sq. ft,
GARAGE: 720 sq. ft, PORCH: 49 sq. ft, DECK: 27 sq. ft

Floor Plan Created By V1photos.com. Measurements Deamed Highly Reliable But Not Guaranteed.



Disclaimer: Sizes and Dimensions are Approximate, Actual May Vary.



Jennifer Hart
720-935-1137
hartrealty1@gmail.com



Scan code
for more
property
details

