



Single Family



3432 SQFT



3 Beds



2 Baths



2 Car



0.24 Acre



**Milissa Everly**  
303-915-3434  
milissa@homesbyshift.com



Scan code  
for more  
property  
details



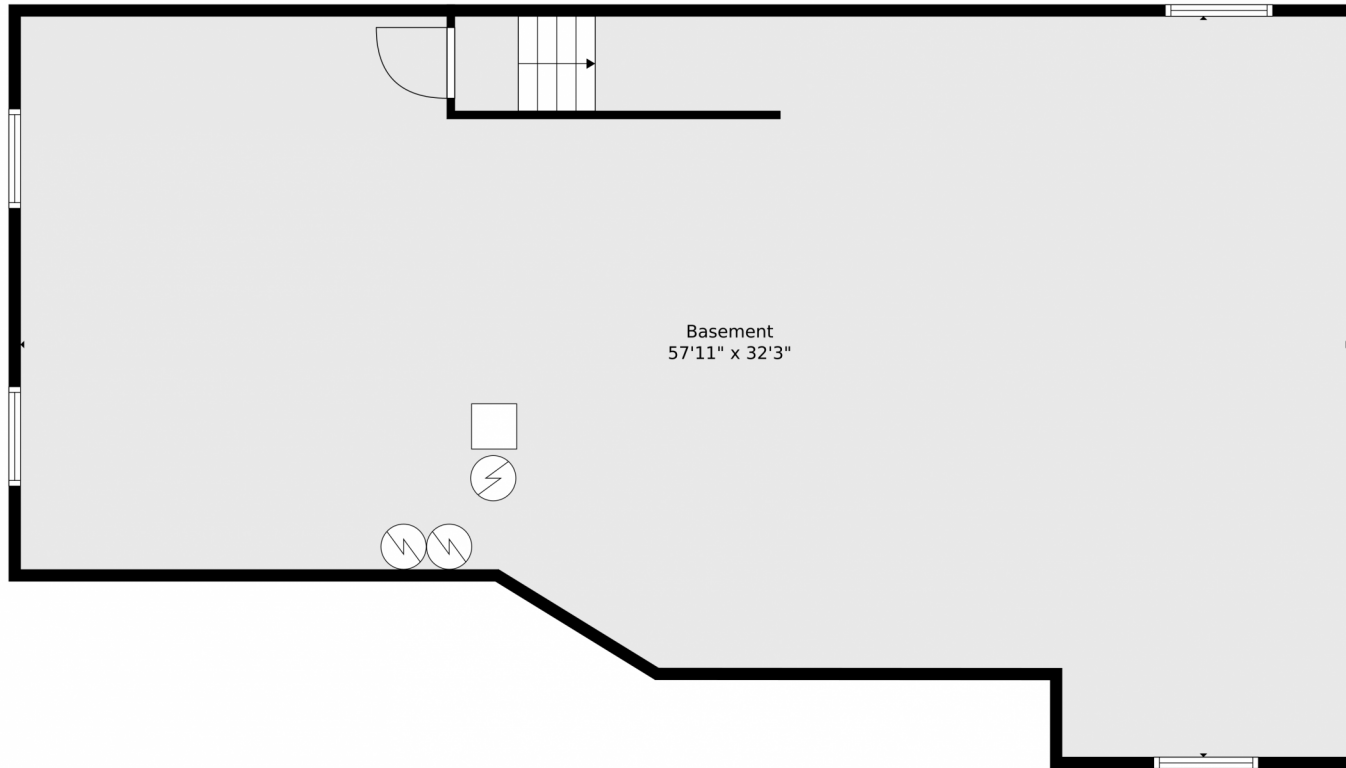

**TOTAL: 1664 sq. ft**  
BELOW GROUND: 0 sq. ft, FLOOR 2: 1664 sq. ft  
EXCLUDED AREAS: BASEMENT: 1589 sq. ft, GARAGE: 695 sq. ft, DECK: 127 sq. ft,  
PORCH: 79 sq. ft

Floor Plan Created By V1photos.com, Measurements Deamed Highly Reliable But Not Guaranteed.



Disclaimer: Sizes and Dimensions are Approximate, Actual May Vary.



**Milissa Everly**  
303-915-3434  
milissa@homesbyshift.com





**TOTAL: 1664 sq. ft**  
BELOW GROUND: 0 sq. ft, FLOOR 2: 1664 sq. ft  
EXCLUDED AREAS: BASEMENT: 1589 sq. ft, GARAGE: 695 sq. ft, DECK: 127 sq. ft,  
PORCH: 79 sq. ft

Floor Plan Created By V1photos.com, Measurements Deamed Highly Reliable But Not Guaranteed.



Disclaimer: Sizes and Dimensions are Approximate, Actual May Vary.



**Milissa Everly**  
303-915-3434  
milissa@homesbyshift.com



Scan code  
for more  
property  
details

# 1124 Monument Street, Calhan, CO 80808 – All Levels



**TOTAL: 1664 sq. ft**  
BELOW GROUND: 0 sq. ft, FLOOR 2: 1664 sq. ft  
EXCLUDED AREAS: BASEMENT: 1589 sq. ft, GARAGE: 695 sq. ft, DECK: 127 sq. ft,  
PORCH: 79 sq. ft

Floor Plan Created By V1photos.com. Measurements Deamed Highly Reliable But Not Guaranteed.



Disclaimer: Sizes and Dimensions are Approximate, Actual May Vary.



**Milissa Everly**  
303-915-3434  
milissa@homesbyshift.com



Scan code  
for more  
property  
details