

RE/MAX GOLD

3604 Wilderness Drive East
Fort Pierce, FL 34982
COMMUNITY: Raintree Forest

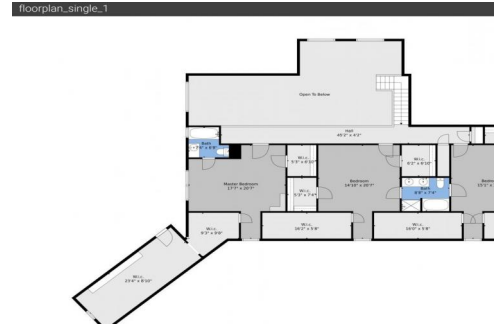

Single Family



3070 SQFT



4 Beds



3/1 Baths



2 Car



0.5 Acre



Kelley Bragg, PA
772-370-9705
kbragg927@gmail.com



Scan code
for more
property
details





TOTAL: 3870 sq. ft
FLOOR 1: 2354 sq. ft, FLOOR 2: 1516 sq. ft
EXCLUDED AREAS: GARAGE: 573 sq. ft, ORCHARD ROOM: 66 sq. ft, SCREENED PORCH: 144 sq. ft,
LOW CEILING: 303 sq. ft, OPEN TO BELOW: 535 sq. ft

Floor Plan Created By V1photos.com, Measurements Deamed Highly Reliable But Not Guaranteed.



Disclaimer: Sizes and Dimensions are Approximate, Actual May Vary.



Kelley Bragg, PA
772-370-9705
kbragg927@gmail.com



Scan code
for more
property
details





TOTAL: 3870 sq. ft
FLOOR 1: 2354 sq. ft, FLOOR 2: 1516 sq. ft
EXCLUDED AREAS: GARAGE: 573 sq. ft, ORCHARD ROOM: 66 sq. ft, SCREENED PORCH: 144 sq. ft,
LOW CEILING: 303 sq. ft, OPEN TO BELOW: 535 sq. ft

Floor Plan Created By V1photos.com, Measurements Deamed Highly Reliable But Not Guaranteed.



Disclaimer: Sizes and Dimensions are Approximate, Actual May Vary.



Kelley Bragg, PA
772-370-9705
kbragg927@gmail.com



Scan code for more property details



3604 Wilderness Drive East, Fort Pierce, FL 34982 — floorplan_all_0



TOTAL: 3870 sq. ft
FLOOR 1: 2354 sq. ft, FLOOR 2: 1516 sq. ft
EXCLUDED AREAS: GARAGE: 573 sq. ft, ORCHARD ROOM: 66 sq. ft, SCREENED PORCH: 144 sq. ft,
LOW CEILING: 303 sq. ft, OPEN TO BELOW: 535 sq. ft

Floor Plan Created By V1photos.com, Measurements Deamed Highly Reliable But Not Guaranteed.



Disclaimer: Sizes and Dimensions are Approximate, Actual May Vary.



Kelley Bragg, PA
772-370-9705
kbragg927@gmail.com

