



1011 47th Avenue  
Greeley, CO 80634  
COMMUNITY: Hilltop



 Single Family

 5444 SQFT

 5 Beds

 4/2 Baths

 3 Car

 0.27 Acre



**Brian Franzen**  
970-301-0266  
brian@briansellsnoco.com



Scan code  
for more  
property  
details





**TOTAL: 4724 sq. ft**  
BELOW GROUND: 2128 sq. ft, FLOOR 2: 2596 sq. ft  
EXCLUDED AREAS: ELECTRICAL ROOM: 187 sq. ft, STORAGE: 213 sq. ft, GARAGE: 878 sq. ft,  
PATIO: 3046 sq. ft, PORCH: 24 sq. ft, BAY WINDOW: 5 sq. ft

Floor Plan Created By V1photos.com, Measurements Deamed Highly Reliable But Not Guaranteed.



Disclaimer: Sizes and Dimensions are Approximate, Actual May Vary.



**Brian Franzen**  
970-301-0266  
brian@briansellsnoco.com



Scan code  
for more  
property  
details



# 1011 47th Avenue, Greeley, CO 80634 – Lower Level



**TOTAL: 4724 sq. ft**  
BELOW GROUND: 2128 sq. ft, FLOOR 2: 2596 sq. ft  
EXCLUDED AREAS: ELECTRICAL ROOM: 187 sq. ft, STORAGE: 213 sq. ft, GARAGE: 878 sq. ft,  
PATIO: 3046 sq. ft, PORCH: 24 sq. ft, BAY WINDOW: 5 sq. ft

Floor Plan Created By V1photos.com, Measurements Deamed Highly Reliable But Not Guaranteed.



Disclaimer: Sizes and Dimensions are Approximate, Actual May Vary.



**Brian Franzen**  
970-301-0266  
brian@briansellsnoco.com





# 1011 47th Avenue, Greeley, CO 80634 – All Levels

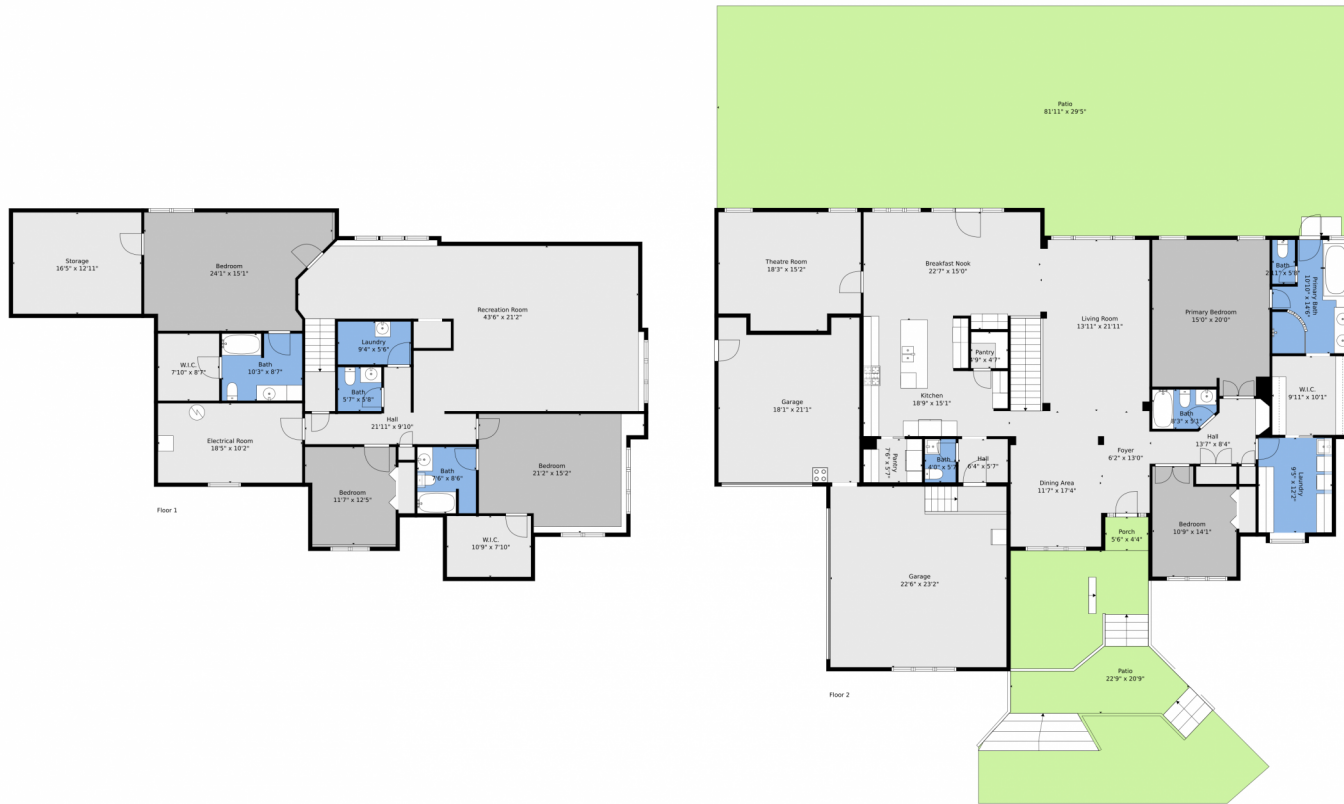

**TOTAL: 4724 sq. ft**  
BELOW GROUND: 2128 sq. ft, FLOOR 2: 2596 sq. ft  
EXCLUDED AREAS: ELECTRICAL ROOM: 187 sq. ft, STORAGE: 213 sq. ft, GARAGE: 878 sq. ft,  
PATIO: 3046 sq. ft, PORCH: 24 sq. ft, BAY WINDOW: 5 sq. ft

Floor Plan Created By V1photos.com, Measurements Deamed Highly Reliable But Not Guaranteed.



Disclaimer: Sizes and Dimensions are Approximate, Actual May Vary.



**Brian Franzen**  
970-301-0266  
brian@briansellsnoco.com



Scan code  
for more  
property  
details

