

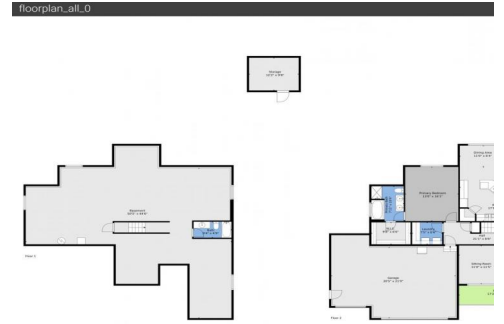

9912 Bradbury Street
 Longmont, CO 80504
 COMMUNITY: Stoneridge

MLS # 4857000
 PRICE \$575,000



 Single Family
  1750 SQFT
  3 Beds
  3 Baths
  3 Car
  0.27 Acre

PROPERTY DETAILS

Charming Ranch Home in Stoneridge Community! Nestled in a quiet cul-de-sac, this well-maintained ranch features 3 bedrooms, 3 bathrooms, an office, and a 3-car garage on a quarter-acre lot. The expansive unfinished basement includes a finished bathroom, offering endless customization potential. The open floor plan boasts vaulted ceilings in the great room, seamlessly connecting to the gourmet kitchen with granite countertops and hardwood floors. The master suite is a private retreat with a 5-piece bath and walk-in closet. Enjoy the spacious backyard with a deck, perfect for entertaining. Conveniently located near shopping, dining, and parks, this home is a true gem!

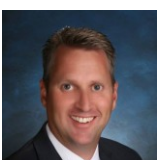

Greg Dach
 303-525-9006
 gregdach@remax.net



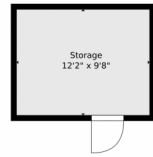

TOTAL: 1650 sq. ft
BELOW GROUND: 53 sq. ft, FLOOR 2: 1597 sq. ft
EXCLUDED AREAS: BASEMENT: 1517 sq. ft, GARAGE: 653 sq. ft, STORAGE: 118 sq. ft,
PORCH: 144 sq. ft, DECK: 133 sq. ft

Floor Plan Created By V1photos.com, Measurements Deamed Highly Reliable But Not Guaranteed.



Disclaimer: Sizes and Dimensions are Approximate, Actual May Vary.



Greg Dach
303-525-9006
gregdach@remax.net



Scan code
for more
property
details



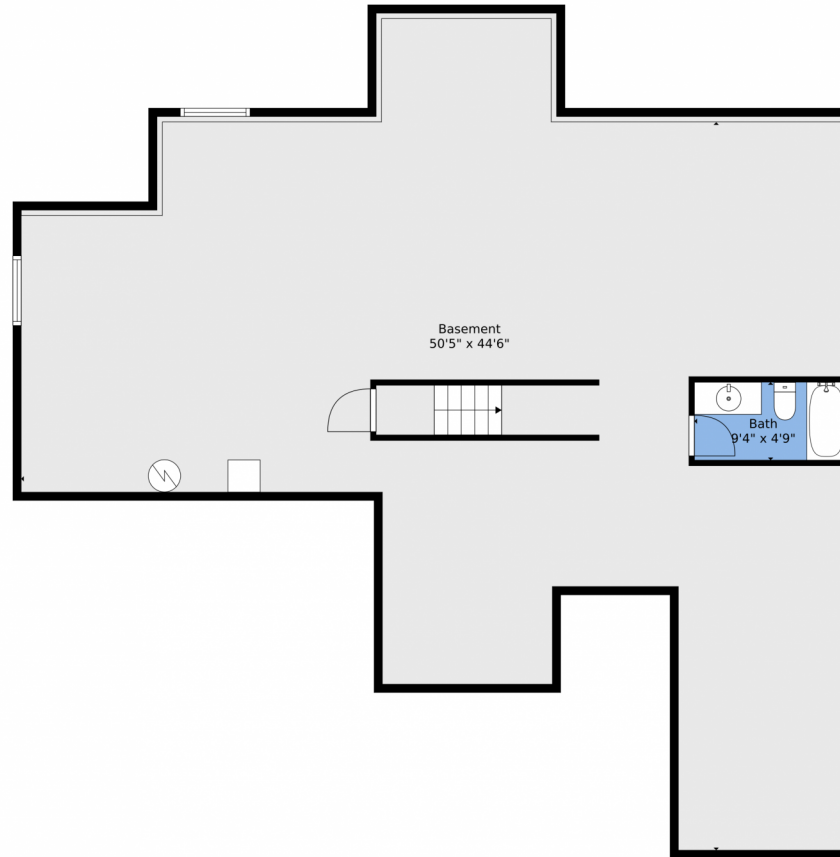

TOTAL: 1650 sq. ft
BELOW GROUND: 53 sq. ft, FLOOR 2: 1597 sq. ft
EXCLUDED AREAS: BASEMENT: 1517 sq. ft, GARAGE: 653 sq. ft, STORAGE: 118 sq. ft,
PORCH: 144 sq. ft, DECK: 133 sq. ft

Floor Plan Created By V1photos.com, Measurements Deamed Highly Reliable But Not Guaranteed.



Disclaimer: Sizes and Dimensions are Approximate, Actual May Vary.



Greg Dach
303-525-9006
gregdach@remax.net



9912 Bradbury Street, Longmont, CO 80504 – All Levels



TOTAL: 1650 sq. ft
BELOW GROUND: 53 sq. ft, FLOOR 2: 1597 sq. ft
EXCLUDED AREAS: BASEMENT: 1517 sq. ft, GARAGE: 653 sq. ft, STORAGE: 118 sq. ft,
PORCH: 144 sq. ft, DECK: 133 sq. ft

Floor Plan Created By V1photos.com, Measurements Deamed Highly Reliable But Not Guaranteed.



Disclaimer: Sizes and Dimensions are Approximate, Actual May Vary.



Greg Dach
303-525-9006
gregdach@remax.net



Scan code
for more
property
details

