

Single Family 3528 SQFT 3 Beds 2/1 Baths 3 Car



Rondi DuPont
970-401-0123
rdupont@thegroupinc.com
<https://rondidupont.com/>



8469 Sand Dollar Drive, Windsor, CO 80528 — Main



TOTAL: 1973 sq. ft
BELOW GROUND: 0 sq. ft, FLOOR 2: 1396 sq. ft, FLOOR 3: 577 sq. ft
EXCLUDED AREAS: BASEMENT: 1293 sq. ft, GARAGE: 610 sq. ft, PORCH: 222 sq. ft,
DECK: 627 sq. ft, PATIO: 274 sq. ft, OPEN TO BELOW: 683 sq. ft,
BAY WINDOW: 10 sq. ft

Floor Plan Created By V1photos.com, Measurements Deamed Highly Reliable But Not Guaranteed.



Disclaimer: Sizes and Dimensions are Approximate, Actual May Vary.



Rondi DuPont
970-401-0123
rdupont@thegroupinc.com
<https://rondidupont.com/>



Scan code
for more
property
details



8469 Sand Dollar Drive, Windsor, CO 80528 — 2nd Level



TOTAL: 1973 sq. ft
BELOW GROUND: 0 sq. ft, FLOOR 2: 1396 sq. ft, FLOOR 3: 577 sq. ft
EXCLUDED AREAS: BASEMENT: 1293 sq. ft, GARAGE: 610 sq. ft, PORCH: 222 sq. ft,
DECK: 627 sq. ft, PATIO: 274 sq. ft, OPEN TO BELOW: 683 sq. ft,
BAY WINDOW: 10 sq. ft

Floor Plan Created By V1photos.com, Measurements Deamed Highly Reliable But Not Guaranteed.



Disclaimer: Sizes and Dimensions are Approximate, Actual May Vary.



Rondi DuPont
970-401-0123
rdupont@thegroupinc.com
<https://rondidupont.com/>



8469 Sand Dollar Drive, Windsor, CO 80528 — Lower Level

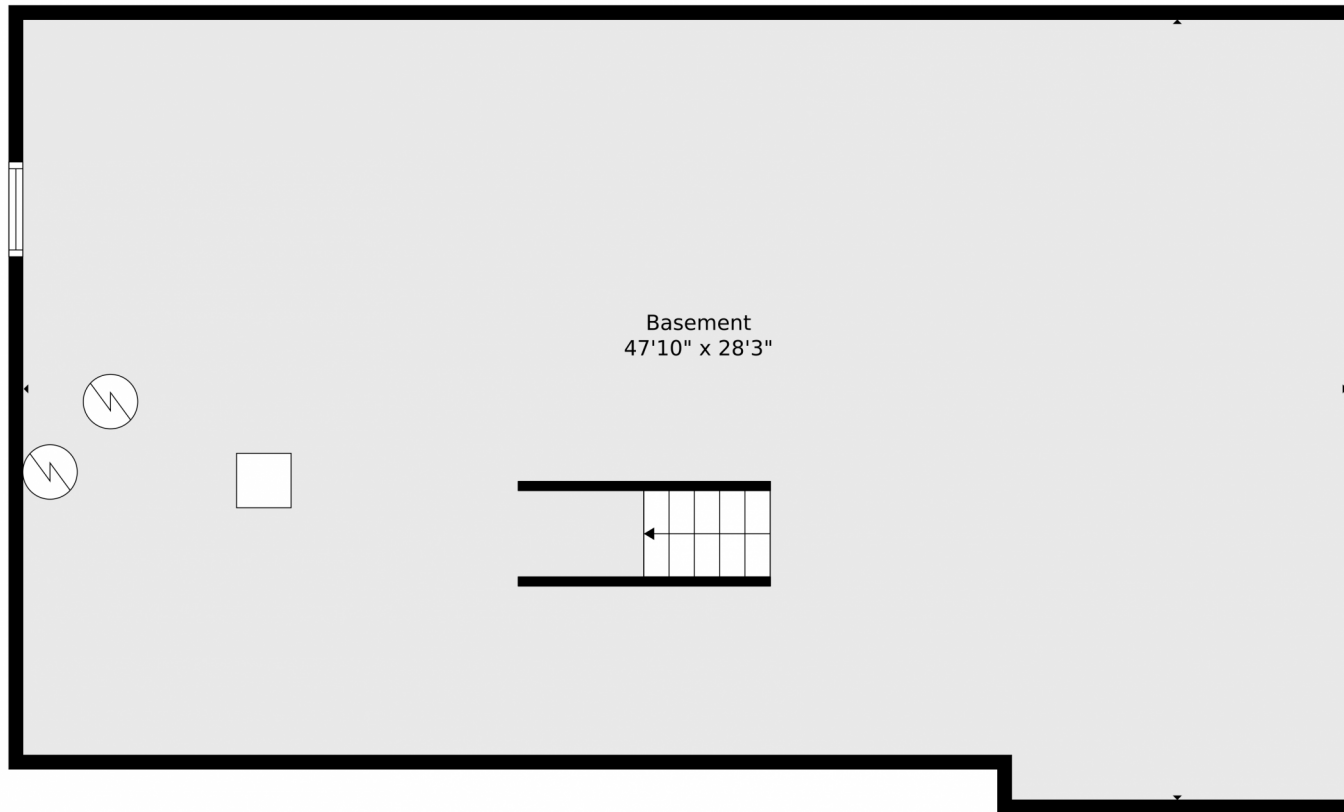

TOTAL: 1973 sq. ft
BELOW GROUND: 0 sq. ft, FLOOR 2: 1396 sq. ft, FLOOR 3: 577 sq. ft
EXCLUDED AREAS: BASEMENT: 1293 sq. ft, GARAGE: 610 sq. ft, PORCH: 222 sq. ft,
DECK: 627 sq. ft, PATIO: 274 sq. ft, OPEN TO BELOW: 683 sq. ft,
BAY WINDOW: 10 sq. ft

Floor Plan Created By V1photos.com, Measurements Deamed Highly Reliable But Not Guaranteed.



Disclaimer: Sizes and Dimensions are Approximate, Actual May Vary.



Rondi DuPont
970-401-0123
rdupont@thegroupinc.com
<https://rondidupont.com/>



8469 Sand Dollar Drive, Windsor, CO 80528 — All Levels

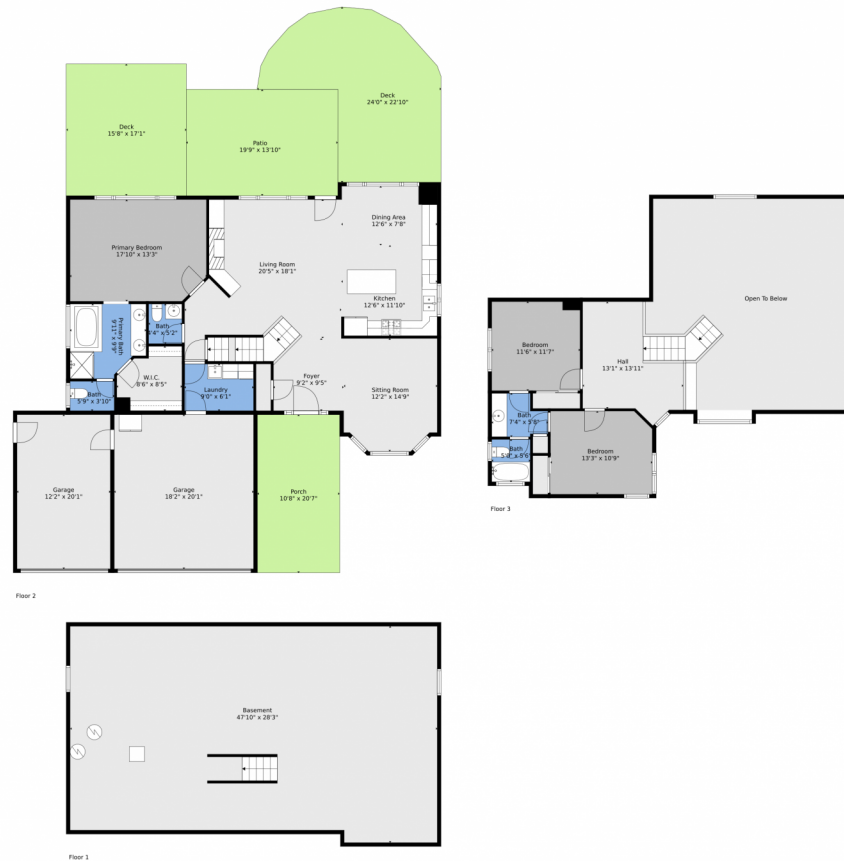

TOTAL: 1973 sq. ft
 BELOW GROUND: 0 sq. ft, FLOOR 2: 1396 sq. ft, FLOOR 3: 577 sq. ft
 EXCLUDED AREAS: BASEMENT: 1293 sq. ft, GARAGE: 610 sq. ft, PORCH: 222 sq. ft,
 DECK: 627 sq. ft, PATIO: 274 sq. ft, OPEN TO BELOW: 683 sq. ft,
 BAY WINDOW: 10 sq. ft

Floor Plan Created By V1photos.com, Measurements Deamed Highly Reliable But Not Guaranteed.



Disclaimer: Sizes and Dimensions are Approximate, Actual May Vary.



Rondi DuPont
 970-401-0123
rdupont@thegroupinc.com
<https://rondidupont.com/>

