

Single Family



2500 SQFT



4 Beds



2 Baths



1 Car



8400 Acre



Brian Franzen
970-301-0266
brian@briansellsnoco.com



Scan code
for more
property
details



1206 23rd Avenue Court, Greeley, CO 80634 – Main



TOTAL: 2212 sq. ft
BELOW GROUND: 1026 sq. ft, FLOOR 2: 1186 sq. ft
EXCLUDED AREAS: UNDEFINED: 23 sq. ft, UTILITY: 130 sq. ft, PATIO: 449 sq. ft,
PORCH: 27 sq. ft, GARAGE: 288 sq. ft

Floor Plan Created By V1photos.com, Measurements Deamed Highly Reliable But Not Guaranteed.



Disclaimer: Sizes and Dimensions are Approximate, Actual May Vary.



Brian Franzen
970-301-0266
brian@briansellsnoco.com



Scan code
for more
property
details



1206 23rd Avenue Court, Greeley, CO 80634 — Lower Level

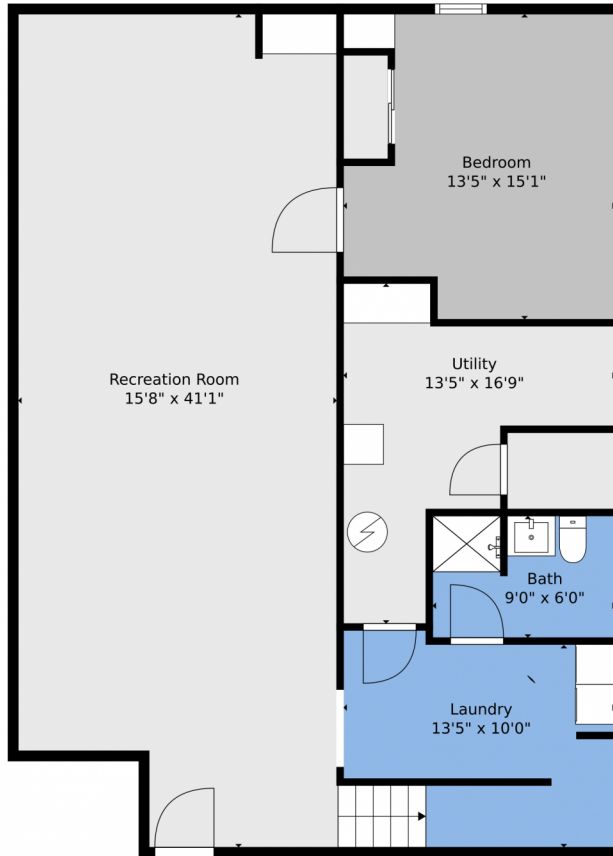

TOTAL: 2212 sq. ft
BELOW GROUND: 1026 sq. ft, FLOOR 2: 1186 sq. ft
EXCLUDED AREAS: UNDEFINED: 23 sq. ft, UTILITY: 130 sq. ft, PATIO: 449 sq. ft,
PORCH: 27 sq. ft, GARAGE: 288 sq. ft

Floor Plan Created By V1photos.com, Measurements Deamed Highly Reliable But Not Guaranteed.



Disclaimer: Sizes and Dimensions are Approximate, Actual May Vary.



Brian Franzen
970-301-0266
brian@briansellsnoco.com



1206 23rd Avenue Court, Greeley, CO 80634 – All Levels



TOTAL: 2212 sq. ft
BELOW GROUND: 1026 sq. ft, FLOOR 2: 1186 sq. ft
EXCLUDED AREAS: UNDEFINED: 23 sq. ft, UTILITY: 130 sq. ft, PATIO: 449 sq. ft,
PORCH: 27 sq. ft, GARAGE: 288 sq. ft

Floor Plan Created By V1photos.com, Measurements Deamed Highly Reliable But Not Guaranteed.



Disclaimer: Sizes and Dimensions are Approximate, Actual May Vary.



Brian Franzen
970-301-0266
brian@briansellsnoco.com



Scan code
for more
property
details

