

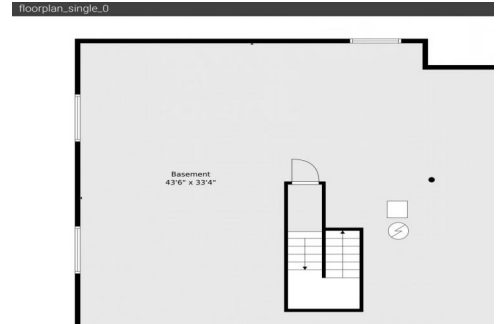

6696 South Quail Court
Littleton, CO 80127
COMMUNITY: Eagle View



Single Family



2100 SQFT



2 Beds



2/1 Baths



3 Car

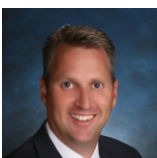

Greg Dach
303-525-9006
gregdach@remax.net



Scan code
for more
property
details



6696 South Quail Court, Littleton, CO 80127 – Main



TOTAL: 2001 sq. ft
BELOW GROUND: 0 sq. ft, FLOOR 2: 2001 sq. ft
EXCLUDED AREAS: BASEMENT: 1418 sq. ft, GARAGE: 665 sq. ft, PATIO: 441 sq. ft,
PORCH: 97 sq. ft
WALLS: 215 sq. ft

Floor Plan Created By V1photos.com, Measurements Deamed Highly Reliable But Not Guaranteed.



Disclaimer: Sizes and Dimensions are Approximate, Actual May Vary.

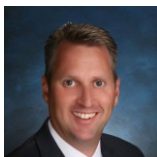

Greg Dach
303-525-9006
gregdach@remax.net



Scan code
for more
property
details



6696 South Quail Court, Littleton, CO 80127 — Basement

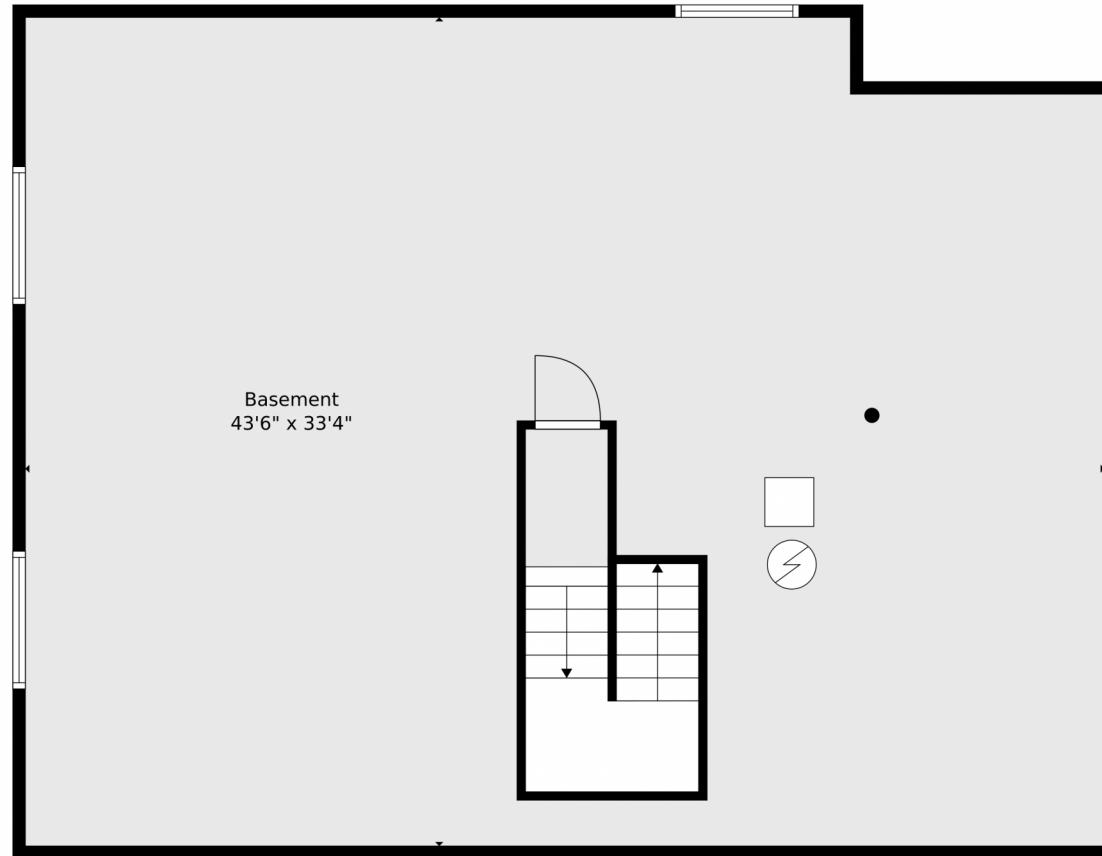

TOTAL: 2001 sq. ft
BELOW GROUND: 0 sq. ft, FLOOR 2: 2001 sq. ft
EXCLUDED AREAS: BASEMENT: 1418 sq. ft, GARAGE: 665 sq. ft, PATIO: 441 sq. ft,
PORCH: 97 sq. ft
WALLS: 215 sq. ft

Floor Plan Created By V1photos.com, Measurements Deamed Highly Reliable But Not Guaranteed.



Disclaimer: Sizes and Dimensions are Approximate, Actual May Vary.



Greg Dach
303-525-9006
gregdach@remax.net



6696 South Quail Court, Littleton, CO 80127 — All Levels

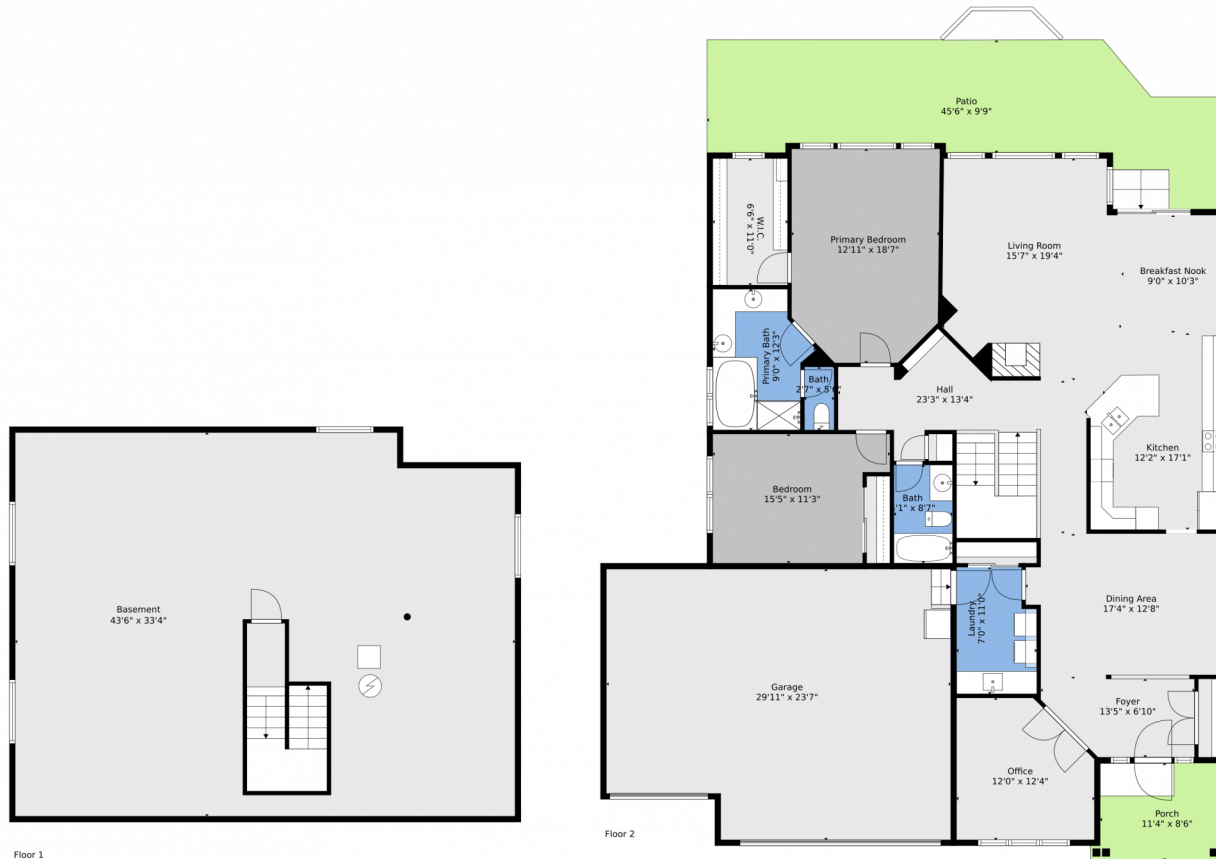

TOTAL: 2001 sq. ft
BELOW GROUND: 0 sq. ft, FLOOR 2: 2001 sq. ft
EXCLUDED AREAS: BASEMENT: 1418 sq. ft, GARAGE: 665 sq. ft, PATIO: 441 sq. ft,
PORCH: 97 sq. ft
WALLS: 215 sq. ft

Floor Plan Created By V1photos.com, Measurements Deamed Highly Reliable But Not Guaranteed.

Disclaimer: Sizes and Dimensions are Approximate, Actual May Vary.



Greg Dach
303-525-9006
gregdach@remax.net

