



13794 W Kentucky Drive
Lakewood, CO 80228
COMMUNITY: Green Mountain

MLS # 1948222
PRICE \$1,875,000



Single Family



6146 SQFT



5 Beds



5/1 Baths



4 Car



0.34 Acre

PROPERTY DETAILS

Perched on Green Mountain, this custom home boasts luxury akin to \$10 million residences. Enter through a stunning 20-foot wrought-iron door into a foyer featuring marble columns and exquisite ceilings. The home showcases solid wood Metropolitan Opera House doors, complemented by custom plasterwork and a mahogany library. Highlights include Czechoslovakian crystal chandeliers, a Bose stereo system, and custom marble and draperies. Designed by renowned Beverly Hills designer Linda Williams, this European-style palace features global antiques and breathtaking views. With 6,125 square feet priced at \$234/sq ft, this is a remarkable opportunity in Colorado.



Julie Leins
720-474-0928
julieleins@kw.com
<https://theleinsgroup.com>



Scan code
for more
property
details



13794 W Kentucky Drive, Lakewood, CO 80228 — Main



TOTAL: 5713 sq. ft

BELOW GROUND: 1940 sq. ft, FLOOR 2: 2039 sq. ft, FLOOR 3: 1734 sq. ft
EXCLUDED AREAS: PATIO: 949 sq. ft, BAY WINDOW: 16 sq. ft, GARAGE: 823 sq. ft,
PORCH: 238 sq. ft, BALCONY: 302 sq. ft, FIREPLACE: 15 sq. ft,
OPEN TO BELOW: 374 sq. ft, WALLS: 371 sq. ft

Floor Plan Created By V1photos.com, Measurements Deamed Highly Reliable But Not Guaranteed.



Disclaimer: Sizes and Dimensions are Approximate, Actual May Vary.



Julie Leins
720-474-0928
julieleins@kw.com
<https://theleinsgroup.com>



Scan code
for more
property
details



13794 W Kentucky Drive, Lakewood, CO 80228 – 2nd Level



TOTAL: 5713 sq. ft
BELOW GROUND: 1940 sq. ft, FLOOR 2: 2039 sq. ft, FLOOR 3: 1734 sq. ft
EXCLUDED AREAS: PATIO: 949 sq. ft, BAY WINDOW: 16 sq. ft, GARAGE: 823 sq. ft,
PORCH: 238 sq. ft, BALCONY: 302 sq. ft, FIREPLACE: 15 sq. ft,
OPEN TO BELOW: 374 sq. ft, WALLS: 371 sq. ft

Floor Plan Created By V1photos.com, Measurements Deamed Highly Reliable But Not Guaranteed.



Disclaimer: Sizes and Dimensions are Approximate, Actual May Vary.



Julie Leins
720-474-0928
julieleins@kw.com
<https://theleinsgroup.com>



Scan code
for more
property
details



13794 W Kentucky Drive, Lakewood, CO 80228 — Lower Level

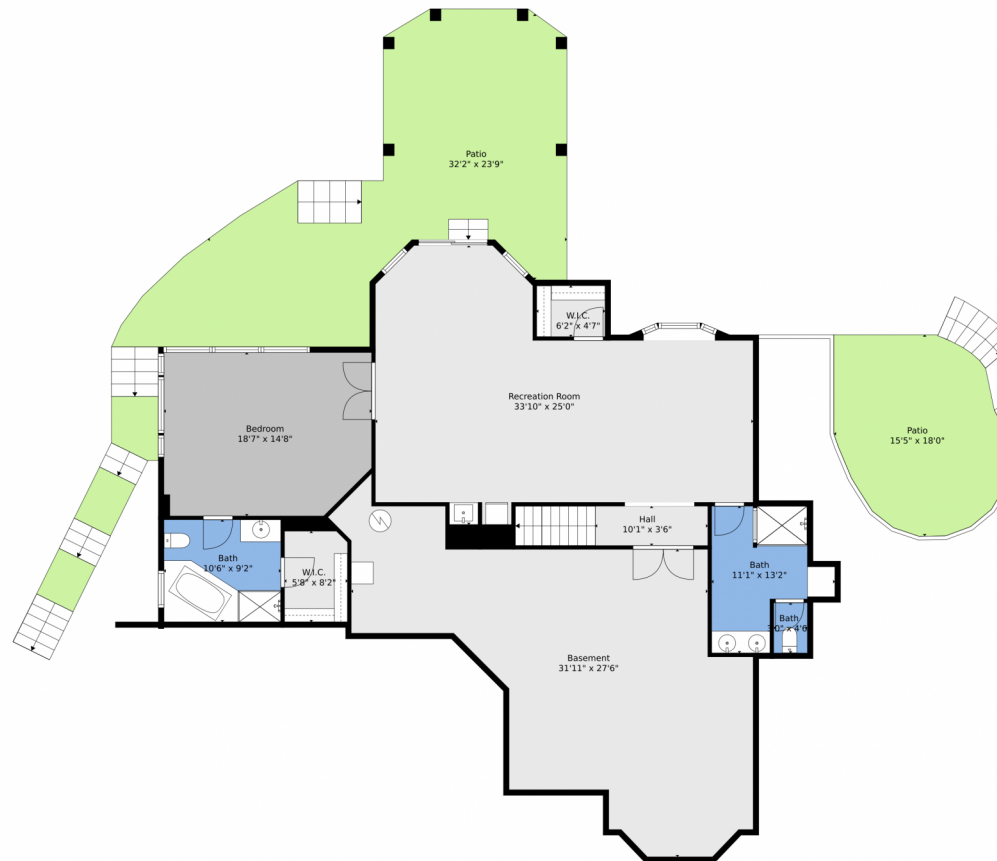

TOTAL: 5713 sq. ft
BELOW GROUND: 1940 sq. ft, FLOOR 2: 2039 sq. ft, FLOOR 3: 1734 sq. ft
EXCLUDED AREAS: PATIO: 949 sq. ft, BAY WINDOW: 16 sq. ft, GARAGE: 823 sq. ft,
PORCH: 238 sq. ft, BALCONY: 302 sq. ft, FIREPLACE: 15 sq. ft,
OPEN TO BELOW: 374 sq. ft, WALLS: 371 sq. ft

Floor Plan Created By V1photos.com, Measurements Deamed Highly Reliable But Not Guaranteed.



Disclaimer: Sizes and Dimensions are Approximate, Actual May Vary.



Julie Leins
720-474-0928
julieleins@kw.com
<https://theleinsgroup.com>



Scan code
for more
property
details



13794 W Kentucky Drive, Lakewood, CO 80228 — All Levels

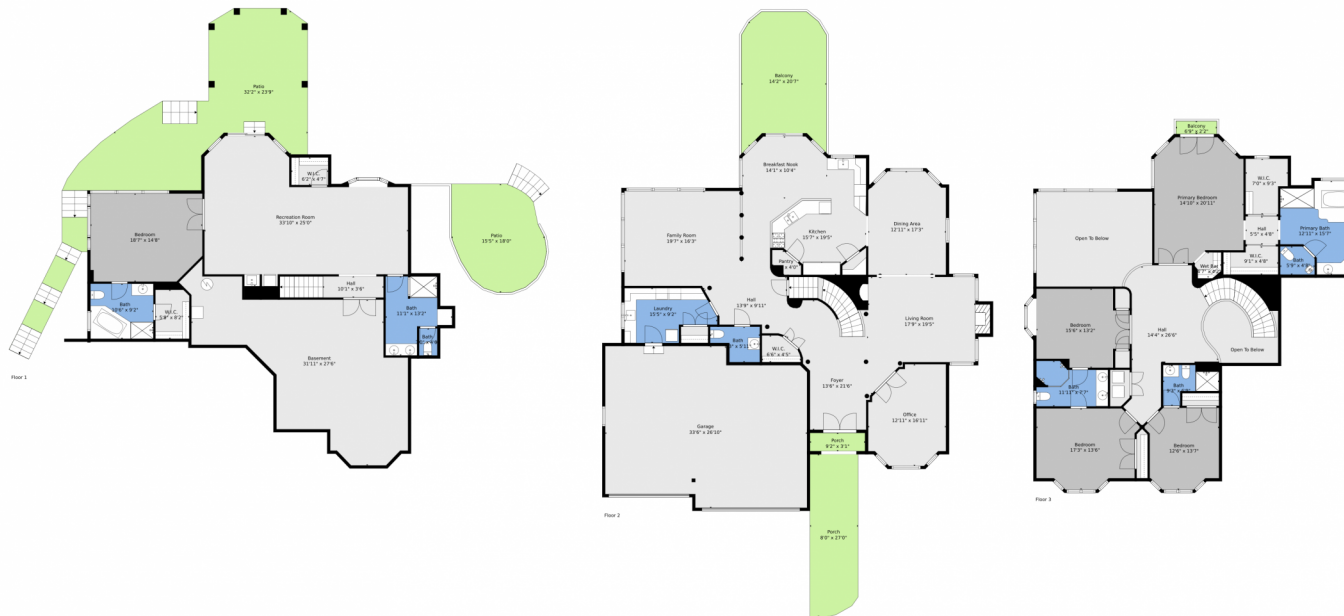

TOTAL: 5713 sq. ft
 BELOW GROUND: 1940 sq. ft, FLOOR 2: 2039 sq. ft, FLOOR 3: 1734 sq. ft
 EXCLUDED AREAS: PATIO: 949 sq. ft, BAY WINDOW: 16 sq. ft, GARAGE: 823 sq. ft,
 PORCH: 238 sq. ft, BALCONY: 302 sq. ft, FIREPLACE: 15 sq. ft,
 OPEN TO BELOW: 374 sq. ft, WALLS: 371 sq. ft

Floor Plan Created By V1photos.com, Measurements Deamed Highly Reliable But Not Guaranteed.



Disclaimer: Sizes and Dimensions are Approximate, Actual May Vary.



Julie Leins
 720-474-0928
 julieleins@kw.com
<https://theleinsgroup.com>



Scan code
 for more
 property
 details

