



3303 Carabiner Street
Castle Rock, CO 80108
COMMUNITY: Macanta

MLS # 2431593
PRICE \$1,180,000

Stunning Ranch Home Backing to Open Space - Gorgeous Views!



Single Family



2587 SQFT



4 Beds



2/1 Baths



4 Car



0.23 Acre

PROPERTY DETAILS

Stunning Ranch Home Backing to Open Space

This beautifully designed ranch home combines comfort, luxury, and functionality. It features 4 main-floor bedrooms, including a home office with French doors. The open-concept great room connects the family room, dining area, and chef's kitchen, all with views of the open space. A moving glass wall in the dining room opens to a covered deck, perfect for entertaining. The kitchen boasts a 12' x 4' island and walk-in pantry.

The spacious primary suite includes a spa-inspired shower, double sinks, and a large walk-in closet. Set on a .22-acre lot, the landscaped backyard features trees, a pond with a waterfall, and a fire pit. Additional highlights include a finished 4-car garage



Josie Apodaca

303-880-1167

apodacateam@gmail.com

<https://www.apodacateam.com/>

Scan code
for more
property
details



and an unfinished walkout basement. The Macanta community offers a clubhouse, fitness facility, and outdoor pool with trails nearby. Enjoy living in Macanta!



Josie Apodaca
303-880-1167
apodacateam@gmail.com
<https://www.apodacateam.com/>



Scan code
for more
property
details



3303 Carabiner Street, Castle Rock, CO 80108 — Main



TOTAL: 2460 sq. ft
BELOW GROUND: 0 sq. ft, FLOOR 2: 2460 sq. ft
EXCLUDED AREAS: BASEMENT: 2460 sq. ft, PATIO: 712 sq. ft, COVERED PATIO: 206 sq. ft,
GARAGE: 755 sq. ft, PORCH: 184 sq. ft, COVERED DECK: 255 sq. ft,
WALLS: 309 sq. ft

Floor Plan Created By V1photos.com, Measurements Deamed Highly Reliable But Not Guaranteed.



Disclaimer: Sizes and Dimensions are Approximate, Actual May Vary.



Josie Apodaca
303-880-1167
apodacateam@gmail.com
<https://www.apodacateam.com/>



Scan code
for more
property
details



3303 Carabiner Street, Castle Rock, CO 80108 — Lower Level

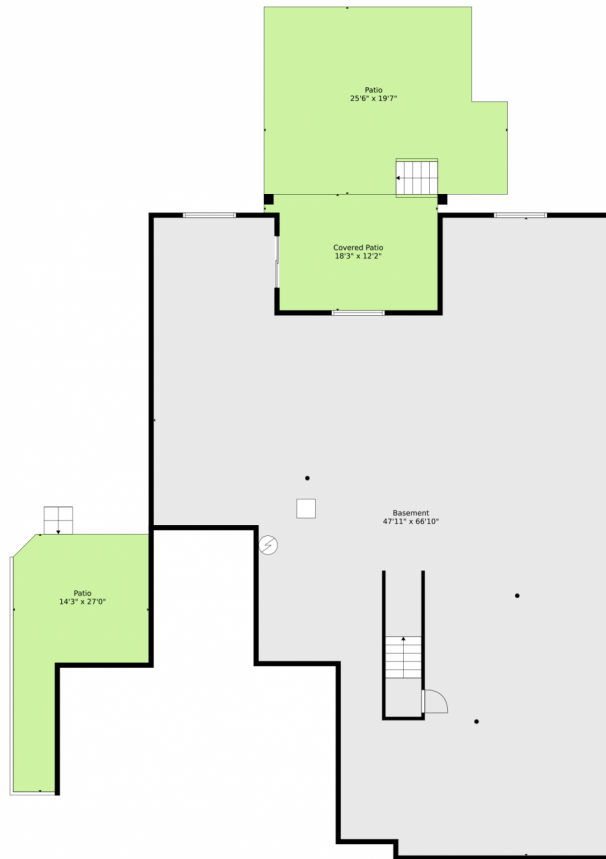

TOTAL: 2460 sq. ft
BELOW GROUND: 0 sq. ft, FLOOR 2: 2460 sq. ft
EXCLUDED AREAS: BASEMENT: 2460 sq. ft, PATIO: 712 sq. ft, COVERED PATIO: 206 sq. ft,
GARAGE: 755 sq. ft, PORCH: 184 sq. ft, COVERED DECK: 255 sq. ft,
WALLS: 309 sq. ft

Floor Plan Created By V1photos.com, Measurements Deamed Highly Reliable But Not Guaranteed.



Disclaimer: Sizes and Dimensions are Approximate, Actual May Vary.



Josie Apodaca
303-880-1167
apodacateam@gmail.com
<https://www.apodacateam.com/>



Scan code
for more
property
details

