



8109 Skyview Street
 Greeley, CO 80634
 COMMUNITY: Poudre River Ranch

MLS # 3356194
 PRICE \$624,000



Single Family 3023 SQFT 4 Beds 3 Baths 3 Car 0.11 Acre

PROPERTY DETAILS

Welcome to this beautifully maintained custom home in Poudre River Ranch. This 4-bedroom, 3-bathroom residence boasts over 3,100 sq. ft. of living space. Inside, an open floor plan features hardwood floors, a gas fireplace, and a chef's kitchen with granite countertops, a gas range, and two pantries. Enjoy the covered balcony for morning coffee or evening relaxation. The main-level primary suite offers a tray ceiling, a spa-like bath, and a walk-in closet. The finished walkout basement is perfect for entertaining, with a bar, guest bedroom, and ¾ bath. The oversized 3-car garage includes custom cabinetry. Additional upgrades include a radon system, smart thermostat, and security system. Residents enjoy walking trails and HOA services. Built in 2014, this home combines custom design with comfort, perfect for gatherings and memories. A pre-listing inspection is available.



Brittany Downs
 720-788-2683
 brittany@exitrealtycherrycreek.com
 http://brokerwithbritt.com/





TOTAL: 2785 sq. ft
BELOW GROUND: 992 sq. ft, FLOOR 2: 1793 sq. ft
EXCLUDED AREAS: BASEMENT: 264 sq. ft, COVERED PATIO: 223 sq. ft, GARAGE: 601 sq. ft,
PORCH: 136 sq. ft, BALCONY: 143 sq. ft, WALLS: 208 sq. ft

Floor Plan Created By V1photos.com, Measurements Deamed Highly Reliable But Not Guaranteed.



Disclaimer: Sizes and Dimensions are Approximate, Actual May Vary.



Brittany Downs
720-788-2683
brittany@exitrealtycherrycreek.com
<http://brokerwithbritt.com/>



Scan code
for more
property
details



8109 Skyview Street, Greeley, CO 80634 – Basement

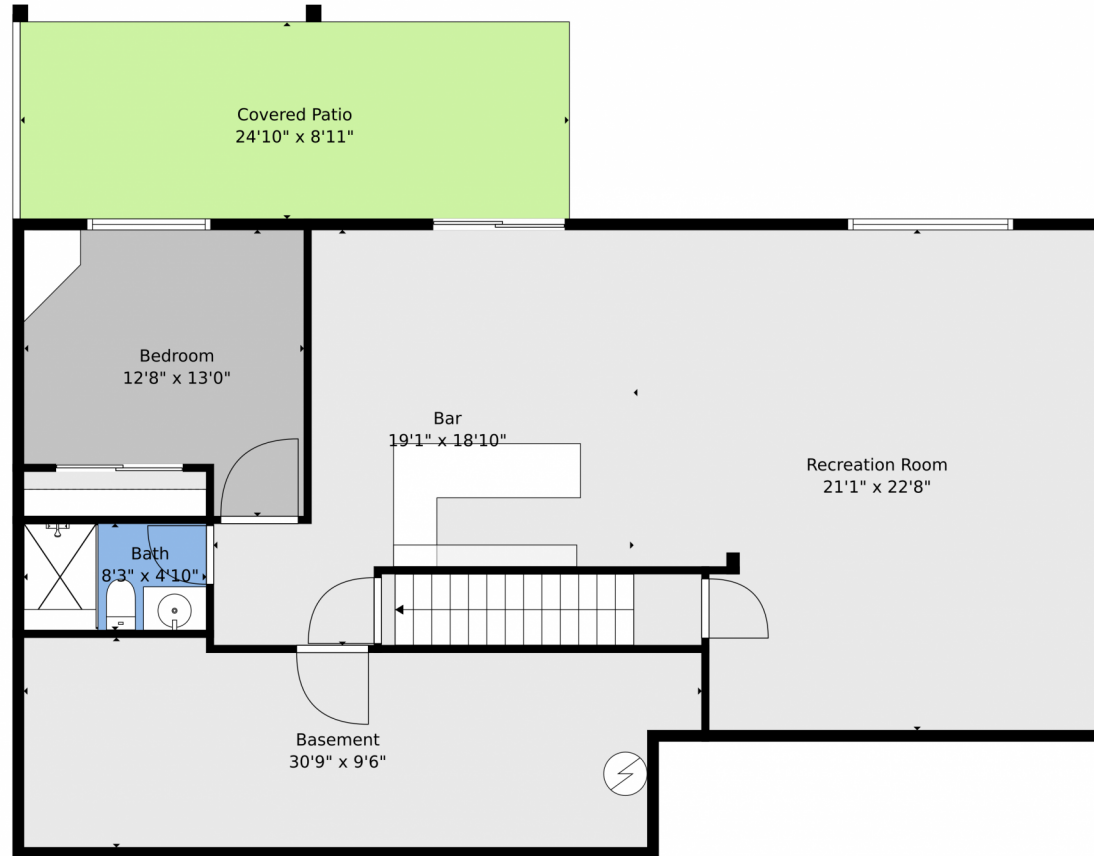

TOTAL: 2785 sq. ft
BELOW GROUND: 992 sq. ft, FLOOR 2: 1793 sq. ft
EXCLUDED AREAS: BASEMENT: 264 sq. ft, COVERED PATIO: 223 sq. ft, GARAGE: 601 sq. ft,
PORCH: 136 sq. ft, BALCONY: 143 sq. ft, WALLS: 208 sq. ft

Floor Plan Created By V1photos.com, Measurements Deamed Highly Reliable But Not Guaranteed.



Disclaimer: Sizes and Dimensions are Approximate, Actual May Vary.



Brittany Downs
720-788-2683
brittany@exitrealtycherrycreek.com
<http://brokerwithbritt.com/>



Scan code
for more
property
details



8109 Skyview Street, Greeley, CO 80634 – All Levels



TOTAL: 2785 sq. ft
BELOW GROUND: 992 sq. ft, FLOOR 2: 1793 sq. ft
EXCLUDED AREAS: BASEMENT: 264 sq. ft, COVERED PATIO: 223 sq. ft, GARAGE: 601 sq. ft,
PORCH: 136 sq. ft, BALCONY: 143 sq. ft, WALLS: 208 sq. ft

Floor Plan Created By V1photos.com, Measurements Deamed Highly Reliable But Not Guaranteed.



Disclaimer: Sizes and Dimensions are Approximate, Actual May Vary.



Brittany Downs
720-788-2683
brittany@exitrealtycherrycreek.com
<http://brokerwithbritt.com/>



Scan code
for more
property
details

