

COMPASS

2247 Eagles Nest Drive
Lafayette, CO 80026
COMMUNITY: Indian Peaks

MLS # 1044518
PRICE \$1,139,000



Single Family



4457 SQFT



4 Beds



4/1 Baths



2 Car



0.2 Acre

PROPERTY DETAILS

Discover 2247 Eagles Nest Dr. in Indian Peaks, a gem in a sought-after neighborhood. This property backs to a serene greenbelt with direct trail access, offering views and open space without the risk of golf balls. Enjoy mature trees, a spacious deck for entertaining, and a backyard retreat for relaxation.

Recent upgrades include fresh interior paint, a reappointed kitchen with new stainless steel appliances, updated light fixtures, and new plumbing fixtures in the primary bath. The home features hardwood floors, a sunlit office, a chef's kitchen with granite countertops, and a vaulted family room with a fireplace.

The primary suite boasts a private deck, a walk-in closet, and a luxurious bath. Generously sized secondary bedrooms each have an attached bath, ensuring everyone has their own space. This beautifully maintained home is ready for your personal touches!



Terra Brewer
720-745-9962
terra.brewer@compass.com
<https://td-propertypartners.com/>



David Rogers
303-854-8278
davidrogers@compass.com



Scan code
for more
property
details



2247 Eagles Nest Drive, Lafayette, CO 80026 — Main

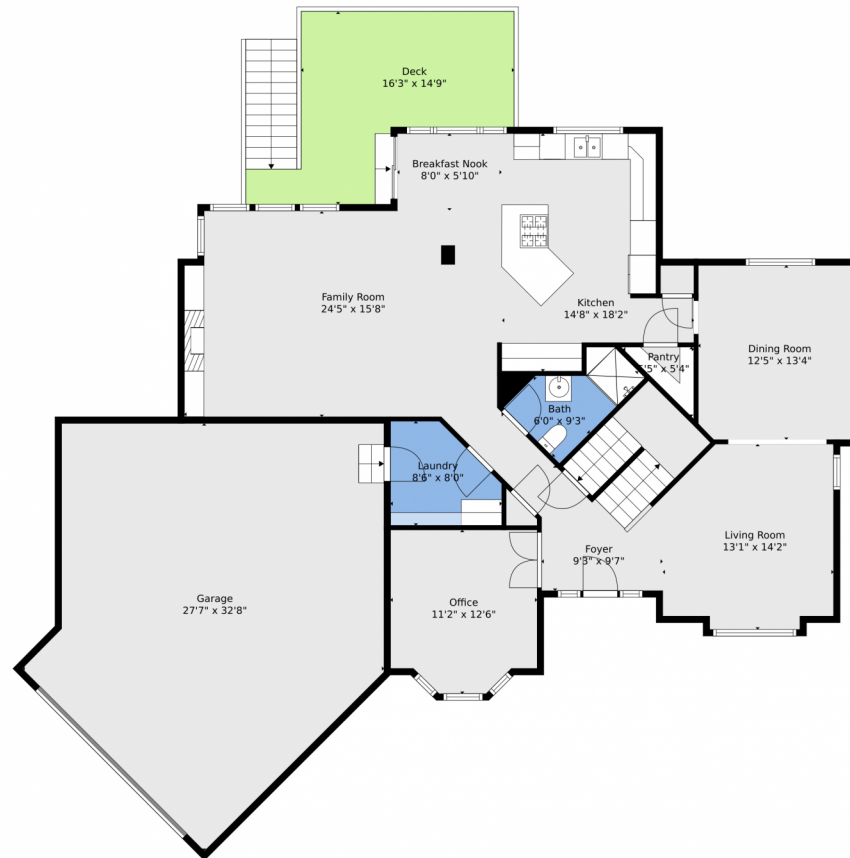

TOTAL: 2757 sq. ft

BELOW GROUND: 0 sq. ft, FLOOR 2: 1423 sq. ft, FLOOR 3: 1334 sq. ft
EXCLUDED AREAS: BASEMENT: 1325 sq. ft, GARAGE: 661 sq. ft, DECK: 234 sq. ft,
BALCONY: 32 sq. ft, OPEN TO BELOW: 518 sq. ft, WALLS: 331 sq. ft

Floor Plan Created By V1photos.com. Measurements Deamed Highly Reliable But Not Guaranteed.



Disclaimer: Sizes and Dimensions are Approximate, Actual May Vary.



Terra Brewer
720-745-9962
terra.brewer@compass.com
<https://td-propertypartners.com/>



David Rogers
303-854-8278
davidrogers@compass.com



Scan code
for more
property
details



2247 Eagles Nest Drive, Lafayette, CO 80026 — 2nd Level



TOTAL: 2757 sq. ft

BELOW GROUND: 0 sq. ft, FLOOR 2: 1423 sq. ft, FLOOR 3: 1334 sq. ft
EXCLUDED AREAS: BASEMENT: 1325 sq. ft, GARAGE: 661 sq. ft, DECK: 234 sq. ft,
BALCONY: 32 sq. ft, OPEN TO BELOW: 518 sq. ft, WALLS: 331 sq. ft

Floor Plan Created By V1photos.com. Measurements Deamed Highly Reliable But Not Guaranteed.



Disclaimer: Sizes and Dimensions are Approximate, Actual May Vary.



Terra Brewer
720-745-9962
terra.brewer@compass.com
<https://td-propertypartners.com/>



David Rogers
303-854-8278
davidrogers@compass.com



Scan code
for more
property
details



2247 Eagles Nest Drive, Lafayette, CO 80026 — Basement

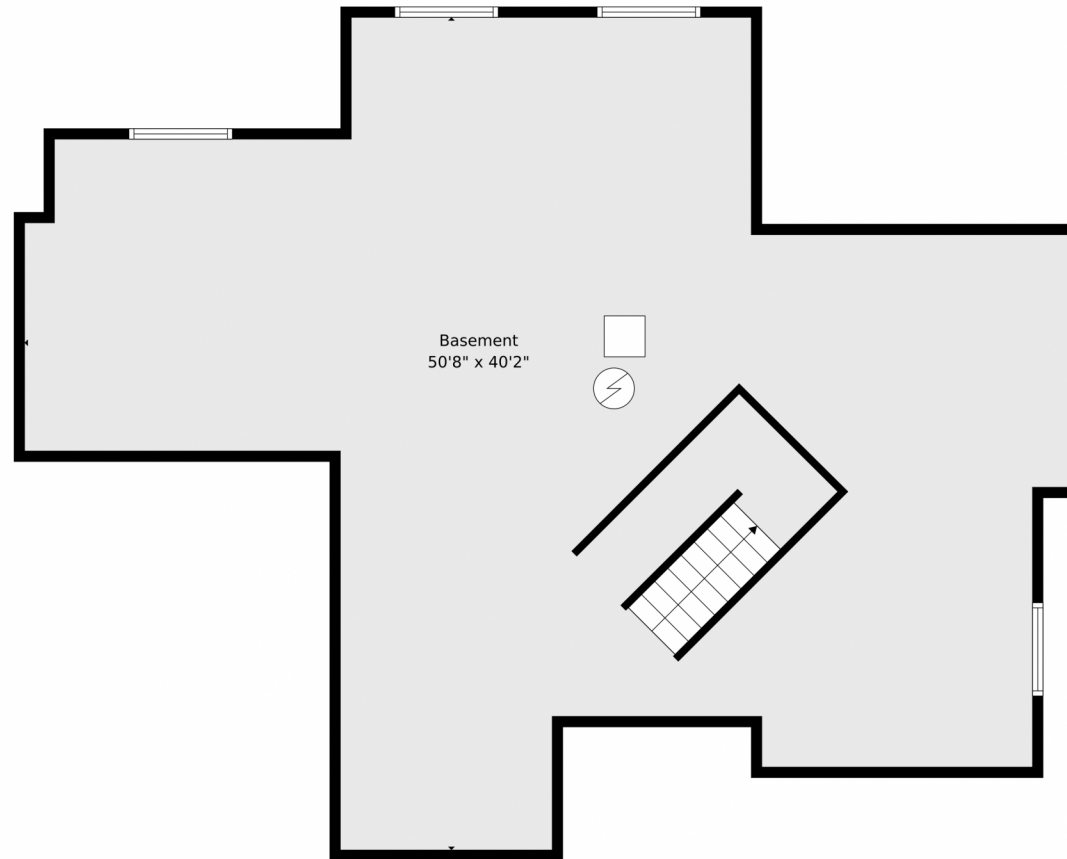

TOTAL: 2757 sq. ft
BELOW GROUND: 0 sq. ft, FLOOR 2: 1423 sq. ft, FLOOR 3: 1334 sq. ft
EXCLUDED AREAS: BASEMENT: 1325 sq. ft, GARAGE: 661 sq. ft, DECK: 234 sq. ft,
BALCONY: 32 sq. ft, OPEN TO BELOW: 518 sq. ft, WALLS: 331 sq. ft

Floor Plan Created By V1photos.com. Measurements Deamed Highly Reliable But Not Guaranteed.



Disclaimer: Sizes and Dimensions are Approximate, Actual May Vary.



Terra Brewer
720-745-9962
terra.brewer@compass.com
<https://td-propertypartners.com/>



David Rogers
303-854-8278
davidrogers@compass.com



Scan code
for more
property
details



2247 Eagles Nest Drive, Lafayette, CO 80026 — All Levels

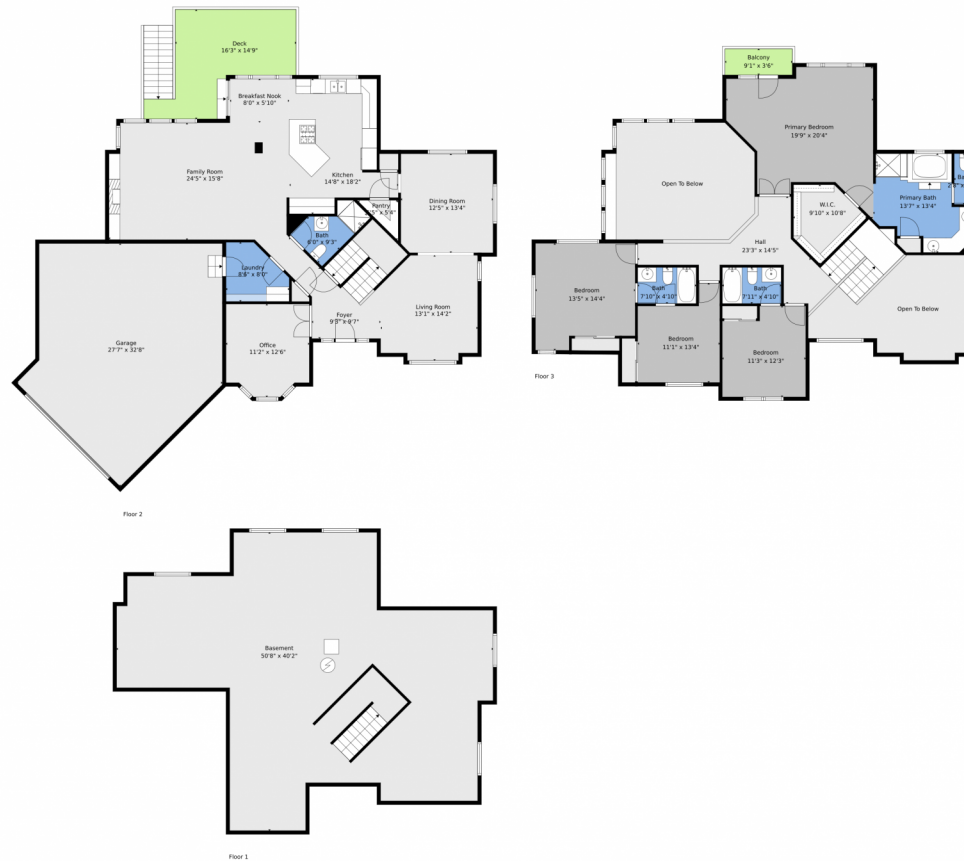

TOTAL: 2757 sq. ft
 BELOW GROUND: 0 sq. ft, FLOOR 2: 1423 sq. ft, FLOOR 3: 1334 sq. ft
 EXCLUDED AREAS: BASEMENT: 1325 sq. ft, GARAGE: 661 sq. ft, DECK: 234 sq. ft,
 BALCONY: 32 sq. ft, OPEN TO BELOW: 518 sq. ft, WALLS: 331 sq. ft

Floor Plan Created By V1photos.com, Measurements Deamed Highly Reliable But Not Guaranteed.



Disclaimer: Sizes and Dimensions are Approximate, Actual May Vary.



Terra Brewer
 720-745-9962
 terra.brewer@compass.com
<https://td-propertypartners.com/>



David Rogers
 303-854-8278
 davidrogers@compass.com



Scan code
 for more
 property
 details

