

## Homestead In The Willows Gem! - Expanded Huntington



Single Family



2383 SQFT

## PROPERTY DETAILS

WOW! Great opportunity in coveted Homestead in the Willows with many recent updates \* As soon as you step into the front entry you will appreciate the large addition that really opened up the main level of this beautiful home \* This expanded Huntington model with 4 bed/3 baths and finished basement is light and bright throughout \* Updates include newly finished REAL hardwood floors on the main level/new carpet upstairs and in basement/brand new Milgard windows upstairs/new paint throughout and a new H2O heater \* Located on a large corner/interior lot with a giant private backyard - One of the best in the neighborhood! \* Enjoy the covered front porch or entertain on the low maintenance back deck or cozy up to the gas fireplace \* All 4 bedrooms are located on 2nd floor including the large primary bedroom w/en suite bathroom and walk-in closet \* Secondary bedrooms are all spacious \* Dining room on main level can also be used as an office \* Finished basement rec room with additional unfinished area for storage/workshop \* \* Roof is stone coated metal shake for extra protection! \* Neighborhood amenities include access to ALL three pools and eight tennis courts \* Serviced by award winning Cherry Creek



**Eric Johnson**

303-718-1947

[eric@door2denver.com](mailto:eric@door2denver.com)

<https://door2denver.com>



Scan code  
for more  
property  
details



Schools \* Close to shopping, restaurants, Denver Tech Center, I-25/C-470 and just a short walk to the coveted Willow Springs open space for walking/running/biking \* The north neighborhood pool and 4 tennis courts are just up the street!



**Eric Johnson**  
303-718-1947  
[eric@door2denver.com](mailto:eric@door2denver.com)  
<https://door2denver.com>



Scan code  
for more  
property  
details



## 6709 East Costilla Circle, Centennial, CO 80112 — Main



**TOTAL: 2809 sq. ft**

BELOW GRADE: 494 sq. ft, 1st floor: 1276 sq. ft, 2nd floor: 1039 sq. ft  
EXCLUDED AREAS: UNDEFINED: 20 sq. ft, BASEMENT: 248 sq. ft, UTILITY: 206 sq. ft,  
GARAGE: 445 sq. ft, PORCH: 177 sq. ft, DECK: 317 sq. ft,  
PATIO: 273 sq. ft, FIREPLACE: 10 sq. ft, WALLS: 235 sq. ft

Floor Plan Created By V1photos.com. Measurements Deamed Highly Reliable But Not Guaranteed.



Disclaimer: Sizes and Dimensions are Approximate, Actual May Vary.



**Eric Johnson**  
303-718-1947  
eric@door2denver.com  
<https://door2denver.com>



Scan code  
for more  
property  
details



## 6709 East Costilla Circle, Centennial, CO 80112 — 2nd Level



**TOTAL: 2809 sq. ft**

BELOW GRADE: 494 sq. ft, 1st floor: 1276 sq. ft, 2nd floor: 1039 sq. ft  
EXCLUDED AREAS: UNDEFINED: 20 sq. ft, BASEMENT: 248 sq. ft, UTILITY: 206 sq. ft,  
GARAGE: 445 sq. ft, PORCH: 177 sq. ft, DECK: 317 sq. ft,  
PATIO: 273 sq. ft, FIREPLACE: 10 sq. ft, WALLS: 235 sq. ft

Floor Plan Created By V1photos.com. Measurements Deamed Highly Reliable But Not Guaranteed.



Disclaimer: Sizes and Dimensions are Approximate, Actual May Vary.



**Eric Johnson**  
303-718-1947  
eric@door2denver.com  
<https://door2denver.com>

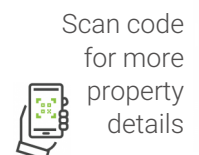

## 6709 East Costilla Circle, Centennial, CO 80112 — Lower Level

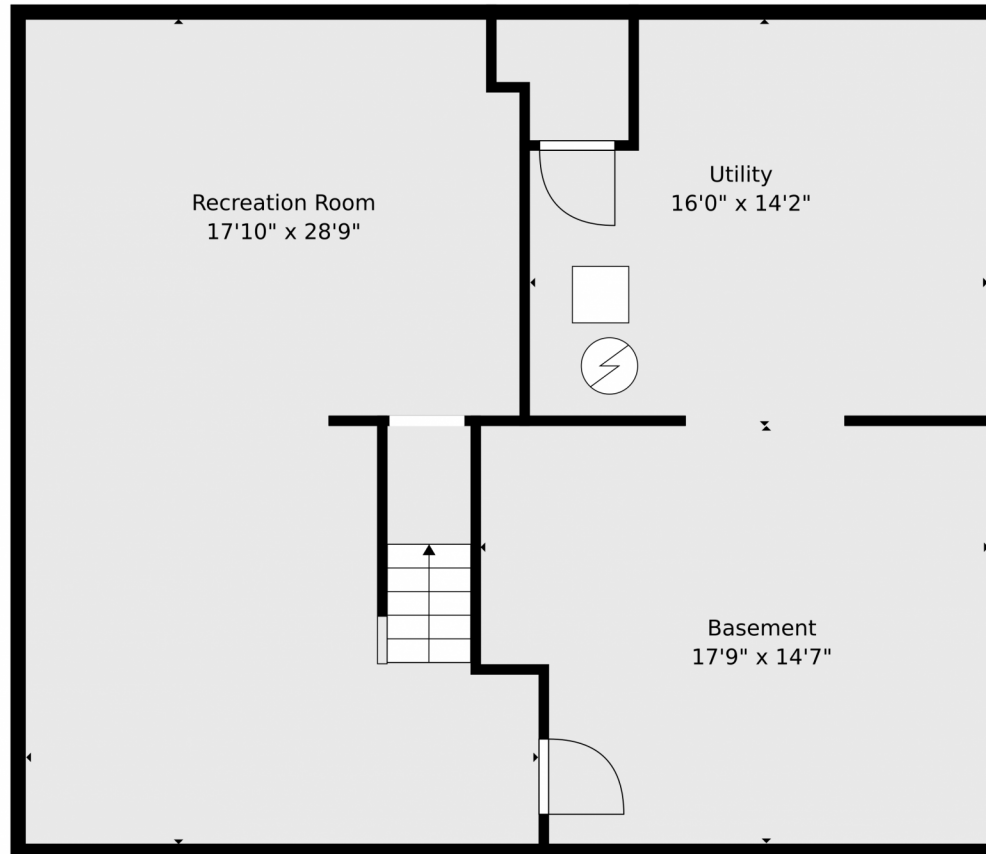

**TOTAL: 2809 sq. ft**  
BELOW GRADE: 494 sq. ft, 1st floor: 1276 sq. ft, 2nd floor: 1039 sq. ft  
EXCLUDED AREAS: UNDEFINED: 20 sq. ft, BASEMENT: 248 sq. ft, UTILITY: 206 sq. ft,  
GARAGE: 445 sq. ft, PORCH: 177 sq. ft, DECK: 317 sq. ft,  
PATIO: 273 sq. ft, FIREPLACE: 10 sq. ft, WALLS: 235 sq. ft

Floor Plan Created By V1photos.com. Measurements Deamed Highly Reliable But Not Guaranteed.



Disclaimer: Sizes and Dimensions are Approximate, Actual May Vary.



**Eric Johnson**  
303-718-1947  
eric@door2denver.com  
<https://door2denver.com>

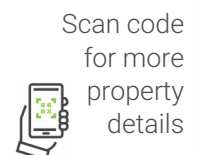

Scan code  
for more  
property  
details



# 6709 East Costilla Circle, Centennial, CO 80112 — All Levels



**TOTAL: 2809 sq. ft**

BELOW GRADE: 494 sq. ft, 1st floor: 1276 sq. ft, 2nd floor: 1039 sq. ft  
 EXCLUDED AREAS: UNDEFINED: 20 sq. ft, BASEMENT: 248 sq. ft, UTILITY: 206 sq. ft,  
 GARAGE: 445 sq. ft, PORCH: 177 sq. ft, DECK: 317 sq. ft,  
 PATIO: 273 sq. ft, FIREPLACE: 10 sq. ft, WALLS: 235 sq. ft

Floor Plan Created By V1photos.com. Measurements Deamed Highly Reliable But Not Guaranteed.



Disclaimer: Sizes and Dimensions are Approximate, Actual May Vary.



**Eric Johnson**  
 303-718-1947  
[eric@door2denver.com](mailto:eric@door2denver.com)  
<https://door2denver.com>

