







13891 Douglass Ranch Drive
 Pine, CO 80470
COMMUNITY: Douglass Ranch

PRICE \$1,500,000

Luxury Mountain Living in Pine



-  Single Family
-  4499 SQFT
-  4 Beds
-  3/2 Baths
-  3 Car
-  5.32 Acre

PROPERTY DETAILS

Welcome home to this beautifully maintained stucco and stone home in the sought-after Douglass Ranch community—where quality craftsmanship meets comfortable main-floor living in a quiet, paved-road neighborhood. Designed for both everyday ease and effortless entertaining, the main level features an open-concept living area filled with natural light, a formal dining room for gatherings, and a dedicated home office—perfect for today’s flexible lifestyle. The spacious primary suite and main living areas on one level make this home ideal for those seeking convenience without compromise. . If you’ve been searching for a custom-finished, move-in ready home with thoughtful design, exceptional care, and easy access on paved roads, this Douglass Ranch property is a must-see. Home details: Private well, 4 bedroom septic suitable for 8 people, Neteo high speed internet, Firewise Community.



Jodi Dolph
 303-902-9968
 jodi.dolph@kw.com
<https://www.TheDolphTeam.com>

Scan code for more property details





13891 Douglass Ranch Drive, Pine, CO 80470 – All Levels

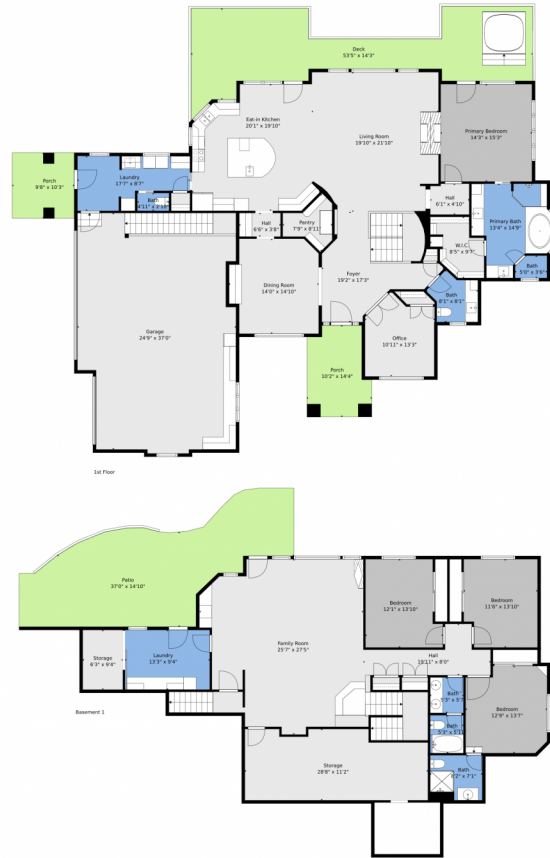

TOTAL: 3784 sq. ft
Basement 1: 1662 sq. ft, 1st floor: 2122 sq. ft
EXCLUDED AREAS: LOW CEILING: 87 sq. ft, STORAGE: 353 sq. ft, PATIO: 531 sq. ft,
GARAGE: 874 sq. ft, DECK: 500 sq. ft, PORCH: 228 sq. ft,
WALLS: 285 sq. ft

Floor Plan Created By V1photos.com. Measurements Deamed Highly Reliable But Not Guaranteed.



Disclaimer: Sizes and Dimensions are Approximate, Actual May Vary.



Jodi Dolph
303-902-9968
jodi.dolph@kw.com
<https://www.TheDolphTeam.com>



Scan code
for more
property
details

