

2334 Lassen Lane
Castle Rock, CO 80109

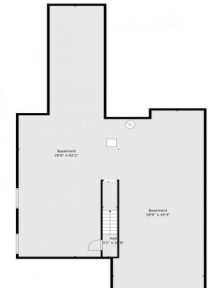

floorplan_single_0



 Single Family  4000 SQFT



Luke Brenning
303-549-1490
luke@mhcrealtygroup.com



2334 Lassen Lane, Castle Rock, CO 80109 – Lower Level

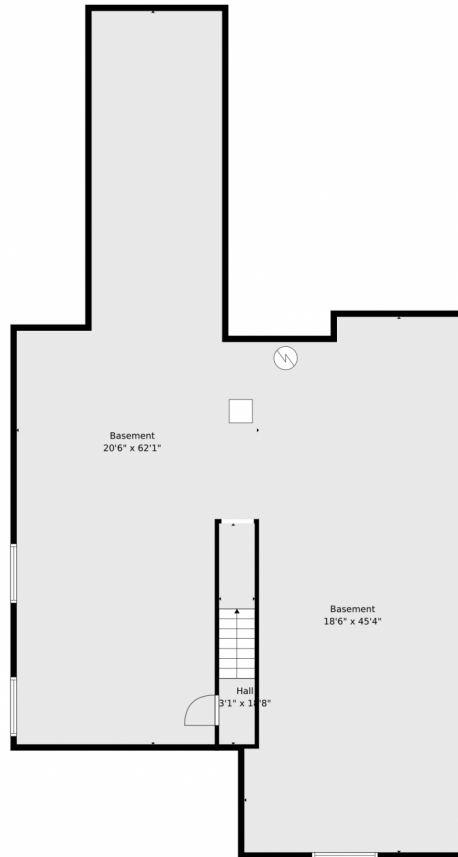

TOTAL: 1993 sq. ft
Basement: 71 sq. ft, 1st floor: 1922 sq. ft
EXCLUDED AREAS: BASEMENT: 1727 sq. ft, PORCH: 232 sq. ft, COVERED PATIO: 109 sq. ft,
GARAGE: 403 sq. ft, WALLS: 247 sq. ft

Floor Plan Created By V1photos.com. Measurements Deamed Highly Reliable But Not Guaranteed.



Disclaimer: Sizes and Dimensions are Approximate, Actual May Vary.



Luke Brenning
303-549-1490
luke@mhcrealtygroup.com



2334 Lassen Lane, Castle Rock, CO 80109 – Main Level



TOTAL: 1993 sq. ft
Basement: 71 sq. ft, 1st floor: 1922 sq. ft
EXCLUDED AREAS: BASEMENT: 1727 sq. ft, PORCH: 232 sq. ft, COVERED PATIO: 109 sq. ft,
GARAGE: 403 sq. ft, WALLS: 247 sq. ft

Floor Plan Created By V1photos.com. Measurements Deamed Highly Reliable But Not Guaranteed.



Disclaimer: Sizes and Dimensions are Approximate, Actual May Vary.



Luke Brenning
303-549-1490
luke@mhcrealtygroup.com



2334 Lassen Lane, Castle Rock, CO 80109 – All Levels



TOTAL: 1993 sq. ft
Basement: 71 sq. ft, 1st floor: 1922 sq. ft
EXCLUDED AREAS: BASEMENT: 1727 sq. ft, PORCH: 232 sq. ft, COVERED PATIO: 109 sq. ft,
GARAGE: 403 sq. ft, WALLS: 247 sq. ft

Floor Plan Created By V1photos.com. Measurements Deamed Highly Reliable But Not Guaranteed.

Disclaimer: Sizes and Dimensions are Approximate, Actual May Vary.



Luke Brenning
303-549-1490
luke@mhcrealtygroup.com

