

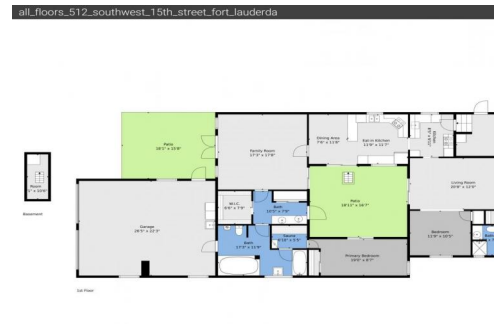

512 Southwest 15th Street  
 Fort Lauderdale, FL 33315  
 COMMUNITY: Croissant Park

PRICE \$640,000

Hot Property in Croissant Park!



Single Family



2882 SQFT



2 Beds



2 Baths



3 Car



0.15 Acre

PROPERTY DETAILS

This unique home can easily be used as two units by closing a door; it's zoned for it. The front has 1 or 2 bedrooms, a full bath, a small kitchen, a large living/dining area, a foyer, and a 1-car garage with laundry. The rear has one bedroom, an eat-in kitchen, and a spacious family room leading to the backyard and courtyard. Enjoy a sauna and a hot or cold deep-plunge tub with beautiful tilework, plus a shower/tub combo and a 2-car garage with alley access. New roof in 2024, it sits high in flood zone X and offers about 2,034 sq ft of living space and 848 sq ft of garage space. Conveniently located near parks, pools, Whole Foods, Publix, downtown, beach, airport, 17th St shops & eateries, and major highways. And... there really is a bomb shelter.

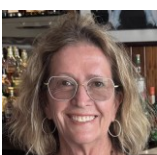

Rhonda Kramer  
 954-294-3360  
 helpme@rhondakramer.com



Scan code  
 for more  
 property  
 details

