



2061 Emerson Lane  
 Superior, CO 80027  
 COMMUNITY: Rock Creek

MLS # 3711695  
 PRICE  
 \$1,099,900

Fantastic 4 bed 4 bath New Build in Rock Creek!



Single Family   3126 SQFT   4 Beds   4 Baths   2 Car   0.17 Acre

PROPERTY DETAILS

Nestled in a quiet cul-de-sac in Rock Creek, this custom-built 2023 home features luxury finishes and exceptional energy efficiency. With 4 bedrooms and 4 baths, it boasts a gourmet kitchen with custom cabinetry, a large granite island, and high-end appliances. The open-concept great room is perfect for entertaining, featuring a cozy fireplace and built-in TV hookups. The primary suite offers heated floors and a spa-like marble bath. The basement is pre-wired for a home theater. Built for durability, it includes energy-efficient features like spray foam insulation and a solar PV system. Outside, enjoy landscaped grounds with a fire-rated Azek deck and custom pergola. This home perfectly combines craftsmanship, efficiency, and location.



**John Bulik & Susie Stewardson with The Summit Team**  
 303-523-4380  
 Susie@you1st.com  
<https://www.SummitTeamColorado.com>



# 2061 Emerson Lane, Superior, CO 80027 – All Levels

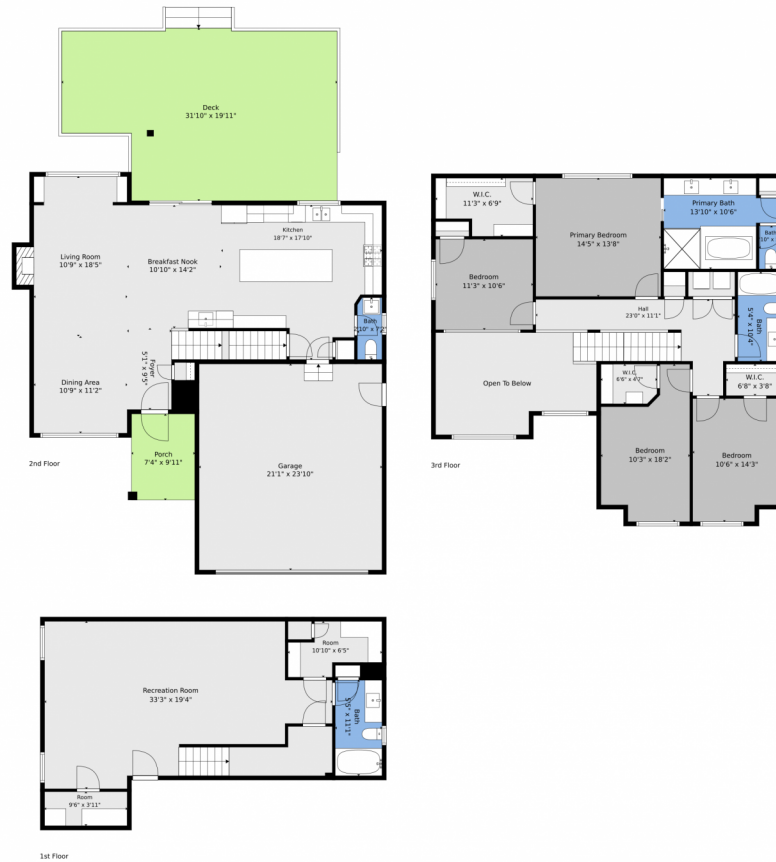

**TOTAL: 2823 sq. ft**  
1st floor: 750 sq. ft, 2nd floor: 892 sq. ft, 3rd floor: 1181 sq. ft  
EXCLUDED AREAS: GARAGE: 503 sq. ft, PORCH: 73 sq. ft, DECK: 563 sq. ft,  
FIREPLACE: 11 sq. ft, OPEN TO BELOW: 188 sq. ft, WALLS: 248 sq. ft

Floor Plan Created By V1photos.com. Measurements Deamed Highly Reliable But Not Guaranteed.



Disclaimer: Sizes and Dimensions are Approximate, Actual May Vary.



John Bulik & Susie Stewardson with The Summit Team

303-523-4380

Susie@you1st.com

<https://www.SummitTeamColorado.com>



Scan code  
for more  
property  
details

