







Outstanding Home in Mira Vista



 Single Family
  4268 SQFT
  5 Beds
  4/1 Baths
  3 Car
  0.16 Acre

PROPERTY DETAILS

Welcome to this exceptional 5-bedroom, 4.5-bath home in the desirable Mira Vista neighborhood. This meticulously maintained residence features a dramatic staircase and an open floor plan with vaulted ceilings. The inviting family room, with a gas fireplace, flows into a stunning kitchen equipped with top-tier stainless steel appliances, a Legacy range, farmhouse sink, and expansive island, perfect for entertaining. The main level also includes a sophisticated home office, a cozy living room, a half bath, and a mudroom with laundry. Upstairs, the luxurious primary suite boasts a walk-in closet and spa-inspired bathroom. 3 additional bedrooms and 2 bathrooms complete the upper level. The newly finished basement offers a great room, wet bar, wine cellar, fifth bedroom, and full bath. Outdoor living shines with an expansive deck, covered seating area, gas fireplace, and outdoor kitchen overlooking a private backyard.

This home showcases custom finishes and impeccable attention to detail, making it truly remarkable.



Cathy Welch
 720-276-6888
 cathymwelch@gmail.com



5424 E Dry Creek Circle, Centennial, CO 80122 — All Levels

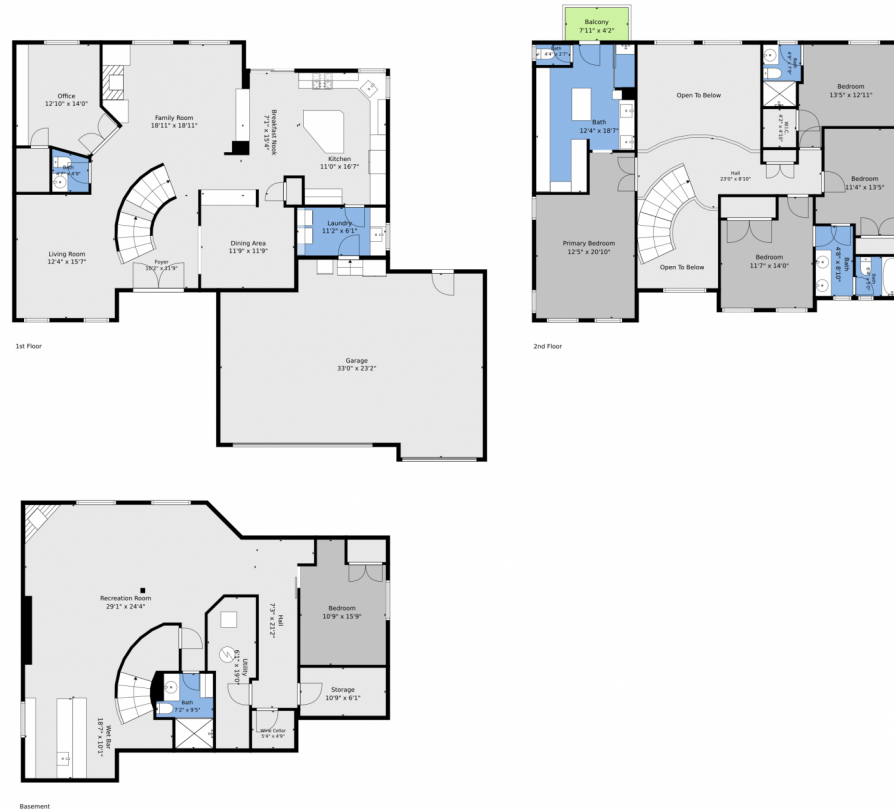

TOTAL: 3720 sq. ft
Basement: 1109 sq. ft, 1st floor: 1361 sq. ft, 2nd floor: 1250 sq. ft
EXCLUDED AREAS: WINE CELLAR: 28 sq. ft, STORAGE: 65 sq. ft, UTILITY: 96 sq. ft,
GARAGE: 719 sq. ft, BALCONY: 33 sq. ft, OPEN TO BELOW: 262 sq. ft,
WALLS: 293 sq. ft

Floor Plan Created By V1photos.com. Measurements Deamed Highly Reliable But Not Guaranteed.



Disclaimer: Sizes and Dimensions are Approximate, Actual May Vary.



Cathy Welch
720-276-6888
cathymwelch@gmail.com



Scan code
for more
property
details

